

# REFERENCES

BOOK  
ENGLISH



# SIMEZA

**TORNUM<sup>®</sup>**



SCAN AND DISCOVER  
**SIMEZA**

SIMEZA has been manufacturing storage silos for cereals, flour, and other industrial products for more than 45 years. It is one of the pioneering companies in Europe with proven experience in the design, production, and installation of corrugated steel sheet silos for industrial, agricultural and livestock uses.

The storage of grain in cylindrical silos made of corrugated steel sheet guarantees perfect conservation and, together with the specific accessories in our catalogue, also excellent ventilation, and management of the stored material, greatly reducing the factors that degrade or reduce the quality of the grain. SIMEZA silos are designed in a modular way, which means that they can be assembled quickly and easily; in addition, the high-quality standards present in the materials used in their construction make them highly resistant in all types of environments, guaranteeing the long-lasting preservation of all types of grain.

THE 360° SOLUTION FOR YOUR STORAGE is the great value proposal that we have been implementing since 1975. The extensive experience and in-depth knowledge of our team, combined with the quality of raw materials and a desire for constant improvement, make up the DNA of our company, and providing global solutions to our customers is our daily inspiration.

The market is the investor's benchmark, and the steel silo market is always moving towards higher technical specification, larger dimensions, more reliable performance, shorter delivery time and extreme product flexibility regarding customer requirements.

SIMEZA is immersed in a determined process of expansion, with the clear objective of transforming the former family business into a company focused on the international market, able to offer its product and services to customers all over the world.

Thanks to the close collaboration with world leading companies in the field of storage, processing and distribution of grains and seeds, SIMEZA is positioned as one of the companies with the greatest capacity for growth in the near future.

SIMEZA is aimed at companies involved in export and import activities and investors in large grain terminals (inland or port) in the context of international trade.

The scope and operation of these terminals, together with the experience of these inverters, are requiring silos with much more stringent specifications than those of agricultural plants, and a size and design concept that allows high performance, reliability, and easy operation of the installation.

This type of investor is one of SIMEZA's new customer profiles, which is why the company has been investing for years in new human resources, mainly of a technical and commercial profile, in order to correctly satisfy all their needs.

Today, we can find installations produced by SIMEZA in dozens of countries, throughout the five continents (Africa, the Middle East, Russia, South America, Eastern Europe, and East Asia), among many other territories.

---

**Depending on the type of product to be stored, the SIMEZA silo catalogue offers a range of capacities from 8 to 25,000 m3.**

**SILOS METÁLICOS ZARAGOZA S.L.U.**

Autovía de Logroño, Km. 14,3  
C/ Francia s/n  
50180 Utebo (Saragossa)  
Spain  
T. +34 976 126 060  
simeza@simeza.com

[www.simeza.com](http://www.simeza.com)





SIMEZA has reference facilities in dozens of countries on five continents.

**AFRICA**

EGYPT  
ANGOLA  
ALGERIA  
SENEGAL  
MOZAMBIQUE  
MOROCCO  
TUNISIA  
KENYA  
MALI  
COTE D'IVOIRE  
SOUTH AFRICA  
LIBYA

**EUROPE (I)**

SPAIN  
ROMANIA  
FRANCE  
PORTUGAL  
GERMANY  
AUSTRIA  
GREECE  
CROATIA  
DENMARK  
NORWAY  
HUNGARY

**EUROPE (II)**

ENGLAND  
NORTHERN  
IRELAND  
ITALY  
SWEDEN  
MOLDOVA  
LITHUANIA  
SERBIA  
ESTONIA  
SWITZERLAND  
BELGIUM  
BULGARIA

**ASIA**

RUSSIA  
TURKEY  
IRAN  
KAZAKHSTAN  
BANGLADESH  
INDONESIA  
SAUDI ARABIA  
CATAR  
UAE  
THAILAND

**AMERICA**

USA  
MEXICO  
GUATEMALA  
VENEZUELA  
URUGUAY  
ECUADOR  
COSTA RICA  
DOMINICAN REPUBLIC  
FRENCH GUIANA

**OCEANIA**

AUSTRALIA  
NEW ZEALAND

**SPAIN**
**SILOS METÁLICOS ZARAGOZA S.L.U.**

Autovía de Logroño, Km. 14,3  
C/ Francia s/n  
50180 Utebo (Saragossa)  
Spain  
T. +34 976 126 060  
simeza@simeza.com



[www.simeza.com](http://www.simeza.com)



**360 DEGREE SOLUTIONS FOR YOUR STORAGE**



# Flat Bottom Silos

**(FBS)**







## Agropecuaria del Centro S.A. Spain

Year: 2021

Product: Wheat

Storage capacity: 13.750 t

**Location:**

Aldeamayor de San Martín, Valladolid (Spain)

**Number and type of Silos:**

4 Flat Bottom Silos FBS 17,60/15

**Accessories:**

Perimeter ladder, vertical ladder and platforms, catwalk.

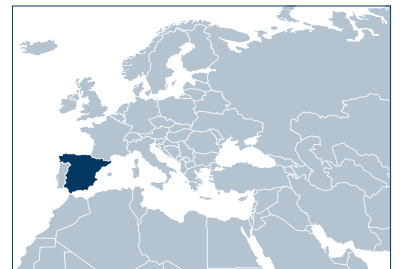

[www.simeza.com](http://www.simeza.com)

**SILOS METÁLICOS ZARAGOZA S.L.U.**

Autovía de Logroño, Km. 14,3

C/ Francia s/n

50180 Utebo (Saragossa)

Spain

T. +34 976 126 060

[simeza@simeza.com](mailto:simeza@simeza.com)



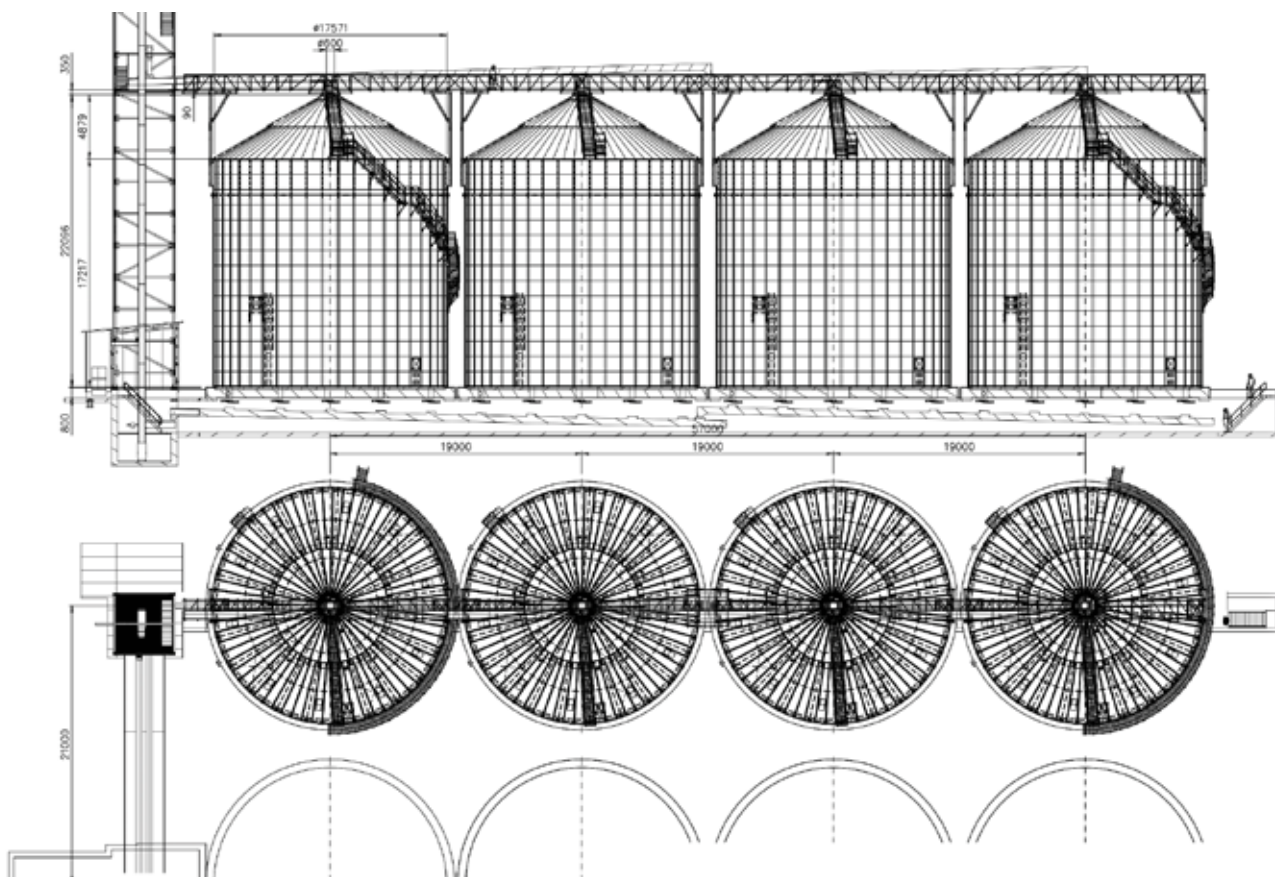

## Products

### Silos

- 4 Flat Bottom Silos FBS 17,60/15

### Steel structures and accessories

- Perimeter ladder
- Vertical ladder and platforms
- Catwalk

## Technical data

Type	FBS
Country	Spain
City	Aldeamayor de San Martín
Customer	Agropecuaria del Centro S.A.
Description	Expansion of the existing plant with a set of 4 flat bottom silos
Product	Wheat
Storage capacity t	13.750
Project partner	PETKUS Spain
Year begin	2021
Year end	2022

## Services

Delivery and supervision of installation of the silo plant and steel structures related to the silo.  
Commissioning.



## Grain Terminal LCC Georgia

Year: 2019

Product: Wheat

Storage capacity: 40.000 t

### Location:

Astara (Georgia)

### Number and type of Silos:

4 Flat Bottom Silos FBS 14,50/16

4 Flat Bottom Silos FBS 21,40/14

2 Flat Bottom Silos FBS 10,70/11

3 Train/Truck Loading Silos TLS 4,60/08/45

### Accessories:

Catwalks, tower, ladders, temperature system, maximum minimum levels, ventilation systems (fans, aeration grids), structure for TLS silos.



[www.simeza.com](http://www.simeza.com)

**SILOS METÁLICOS ZARAGOZA S.L.U.**

Autovía de Logroño, Km. 14,3

C/ Francia s/n

50180 Utebo (Saragossa)

Spain

T. +34 976 126 060

[simeza@simeza.com](mailto:simeza@simeza.com)





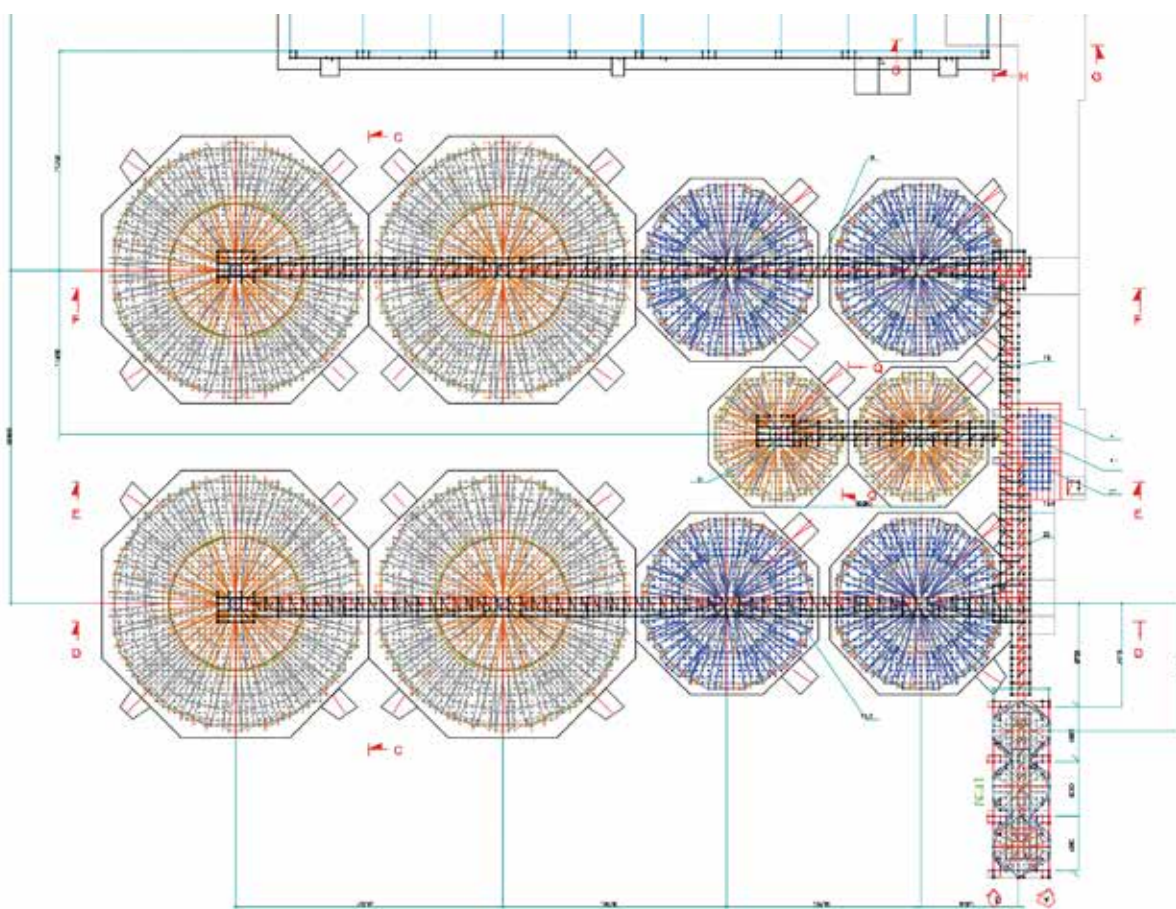

## Products

### Silos

- 4 Flat Bottom Silos FBS 14,50/16
- 4 Flat Bottom Silos FBS 21,40/14
- 2 Flat Bottom Silos FBS 10,70/11
- 3 Train/Truck Loading Silos TLS 4,60/08/45

### Steel structures and accessories

- Catwalks
- Tower
- Ladders
- Temperature system,
- Maximum minimum levels
- Ventilation systems (fans, aeration grids)
- Structure for TLS silos

## Technical data

Type	FBS + TLS
Country	Georgia
City	Astara
Customer	Grain Terminal LCC
Description	Storage plant located in a logistics hub for the transloading of grains in the Caspian region
Product	Wheat
Storage capacity t	40.000
Project partner	PETKUS Engineering
Year begin	2019
Year end	2021

## Services

Basic and Detail Engineering and design of the general layout and flow-chart of the whole plant.

Design of architectural drawing for the civil works calculation and realization.

Steel structures design and static calculation.

Delivery and installation of the silo plant and steel components.



## AlSahal Group Libya

Year: 2018

Product: Wheat, barely and rice

Storage capacity: 119.500 t

### Location:

Tobrouk, Tripoli and Benghazi (Libya)

### Number and type of Silos:

23 Flat Bottom Silos FBS 22,20/13

20 Truck Loading Silos TLS 4,60/6/45

7 Truck Loading Silos TLS 3,80/5/45

### Accessories:

Vertical ladder and platforms, catwalks, sweep augers and thermometry.

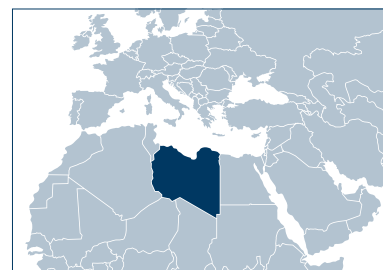

[www.simeza.com](http://www.simeza.com)

**SILOS METÁLICOS ZARAGOZA S.L.U.**

Autovía de Logroño, Km. 14,3

C/ Francia s/n

50180 Utebo (Saragossa)

Spain

T. +34 976 126 060

[simeza@simeza.com](mailto:simeza@simeza.com)



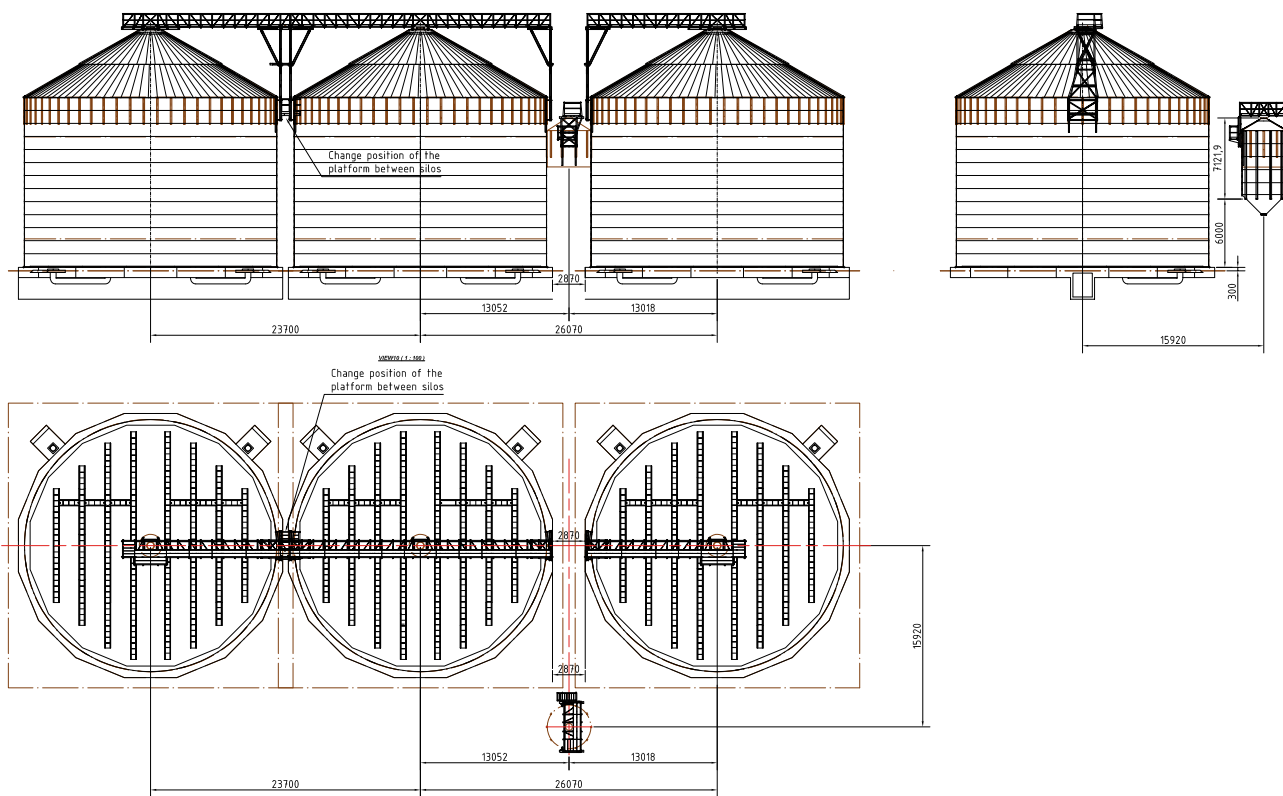

## Products

### Silos

- 23 Flat Bottom Silos FBS 22,20/13
- 20 Truck Loading Silos TLS 4,60/6/45
- 7 Truck Loading Silos TLS 3,80/5/45

### Steel structures and accessories

- Vertical ladder and platforms
- Catwalk
- Sweep Augers
- Thermometry

## Technical data

Type	FBS + TLS
Country	Libya
City	Tobrouk, Tripoli and Benghazi
Customer	AlSahal Group
Description	Storage Plant for wheat, barley and rice
Product	Wheat, barley and rice
Storage capacity t	119.500
Project partner	-
Year begin	2018
Year end	2022

## Services

Basic and Detail Engineering and design of the general layout and flow-chart of the storage area of the plants.

Design of architectural drawing for the civil works calculation and realization.

Steel structures design and static calculation.

Delivery of the silo plant and metallic structures.





## CONVEX International GmbH Ukraine

Year: 2020

Product: Wheat

Storage capacity: 97.000 t

### Location:

Kyiv (Ukraine)

### Number and type of Silos:

4 Flat Bottom Silos FBS 30,60/14

8 Flat Bottom Silos FBS 19,90/17

8 Hopper Bottom Silos HBS-S 10,70/15/45

2 Hopper Bottom Silos HBS-S 8,40/14/45

3 Hopper Bottom Silos HBS-S 8,40/20/45

### Accessories:

Vertical ladder and platforms, catwalk, thermometry, aeration system, pre laquered roofs.



[www.simeza.com](http://www.simeza.com)

**SILOS METÁLICOS ZARAGOZA S.L.U.**

Autovía de Logroño, Km. 14,3

C/ Francia s/n

50180 Utebo (Saragossa)

Spain

T. +34 976 126 060

[simeza@simeza.com](mailto:simeza@simeza.com)



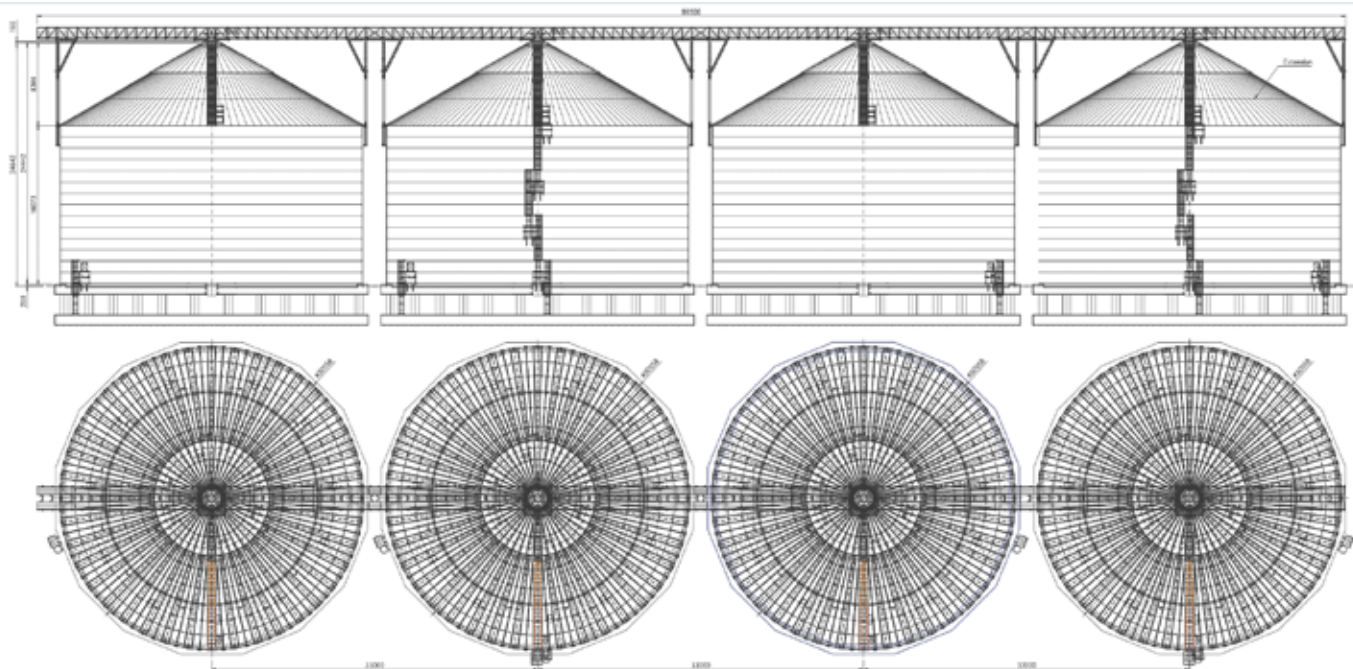

## Products

### Silos

- 4 Flat Bottom Silos FBS 30,60/14
- 8 Flat Bottom Silos FBS 19,90/17
- 8 Hopper Bottom Silos HBS-S 10,70/15/45
- 2 Hopper Bottom Silos HBS-S 8,40/14/45
- 3 Hopper Bottom Silos HBS-S 8,40/20/45

### Steel structures and accessories

- Vertical ladder and platforms
- Catwalk
- Thermometry
- Aeration system
- Pre laquered roofs

## Technical data

Type	FBS + HBS-S
Country	Ukraine
City	Kyiv
Customer	CONVEX International GmbH
Description	Storage Plant for wheat
Product	Wheat
Storage capacity t	97.000
Project partner	CONVEX International GmbH
Year begin	2020
Year end	2021

## Services

Basic and Detail Engineering and design of the general layout and flow-chart of the storage area of the plants.

Design of architectural drawing for the civil works calculation and realization.

Steel structures design and static calculation.

Delivery of the silo plant and metallic structures.





## Ayerbe Plantas Ind. de Secado S.L. Spain

Year: 2014

Product: Wheat

Storage capacity: 60.000 t

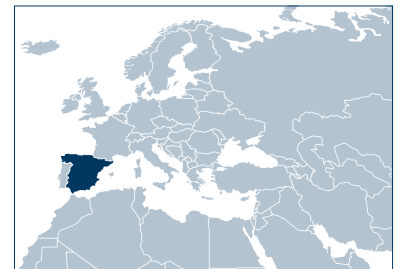

### Location:

Binéfar (Huesca)

### Number and type of Silos:

12 Flat Bottom Silos FBS 21,40/15

4 Hopper Bottom Silos HBS 9,20/15/45

### Accessories:

Vertical ladder and platforms, catwalk, special roof with perimetral aeration, oven painted roof and cylinder.



[www.simeza.com](http://www.simeza.com)

**SILOS METÁLICOS ZARAGOZA S.L.U.**

Autovía de Logroño, Km. 14,3

C/ Francia s/n

50180 Utebo (Saragossa)

Spain

T. +34 976 126 060

[simeza@simeza.com](mailto:simeza@simeza.com)





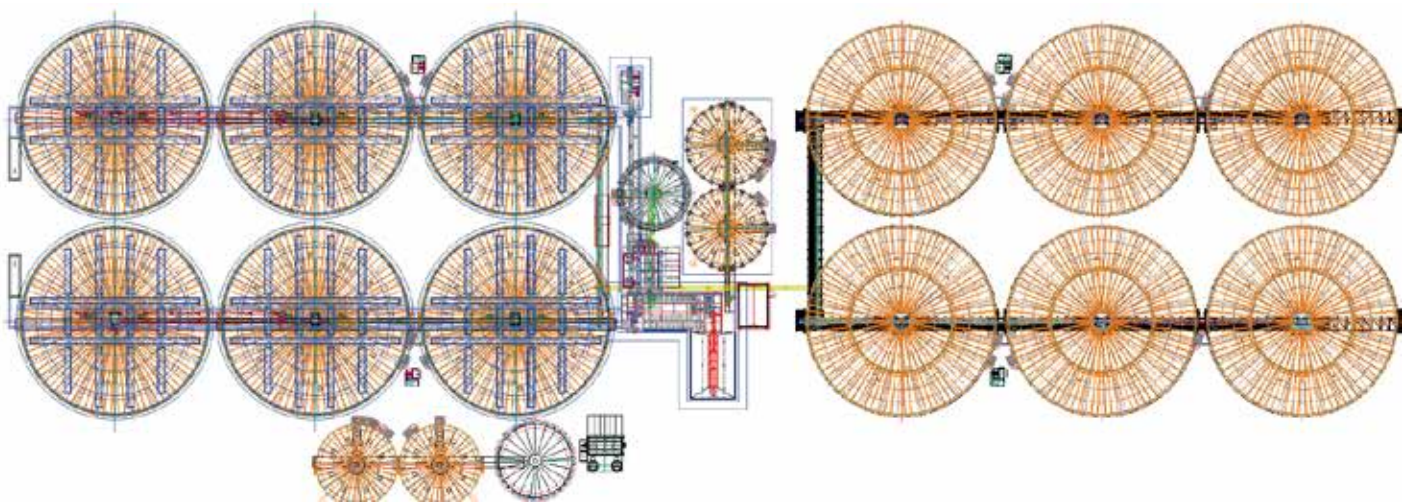

## Products

### Silos

- 12 Flat Bottom Silos FBS 21,40/15
- 4 Hopper Bottom Silos HBS 9,20/15/45

### Steel structures and accessories

- Vertical ladder and platforms
- Catwalk
- Special roof with perimetral aereation
- Owen painted roof and cylinder.

## Technical data

Type	FBS + HBS
Country	Spain
City	Binéfar, Huesca
Customer	Ayerbe Plantas Ind. de Secado S.L.
Description	Storage Plant for wheat
Product	Wheat
Storage capacity t	60.000
Project partner	Ayerbe Plantas Ind. de Secado S.L.
Year begin	2014
Year end	2017

## Services

Delivery and supervision of installation of the silo plant and steel structures related to the silo.  
 Owen painted roof and cylinder.  
 Commissioning.



## Technobins Italy

Year: 2021

Product: Wheat

Storage capacity: 5.000 t

**Location:**

Castellaneta (Italy)

**Number and type of Silos:**

4 Flat Bottom Silos FBS 12,20/11

**Accessories:**

Level indicator, walkways, platform and ladders.



[www.simeza.com](http://www.simeza.com)

**SILOS METÁLICOS ZARAGOZA S.L.U.**

Autovía de Logroño, Km. 14,3

C/ Francia s/n

50180 Utebo (Saragossa)

Spain

T. +34 976 126 060

[simeza@simeza.com](mailto:simeza@simeza.com)



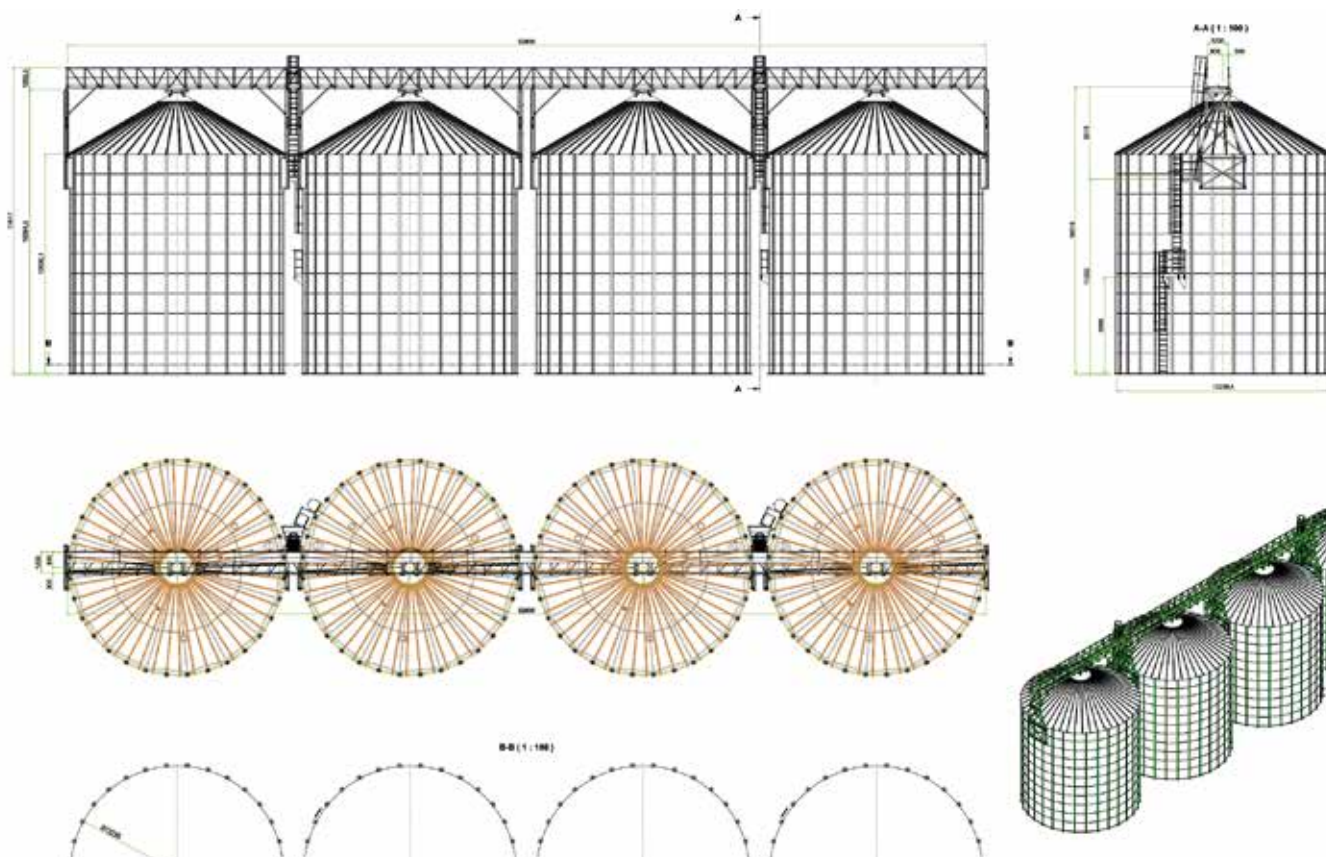

## Products

### Silos

- 4 Flat Bottom Silos FBS 12,20/11

### Steel structures and accessories

- Level indicator
- Walkways
- Platform
- Ladders

## Technical data

Type	FBS
Country	Italy
City	Castellaneta
Customer	Technobins
Description	Storage Plant for wheat
Product	Wheat
Storage capacity t	5,000
Project partner	Technobins
Year begin	2021
Year end	2021

## Services

Basic and Detail Engineering and design of the general layout and flow-chart of the storage area of the plants.

Design of architectural drawing for the civil works calculation and realization.

Steel structures design and static calculation.

Delivery of the silo plant and metallic structures.





## Al Masirah International Industrial Investments Co LTD. Saudi Arabia

Year: 2019

Product: Wheat

Storage capacity: 20.000 t

### Location:

Jeddah (Saudi Arabia)

### Number and type of Silos:

4 Flat Bottom Silos FBS 21,40/14

2 Truck Loading Silos TLS-S 5,30/08/45

1 Truck Loading Silo TLS-S 4,60/07/60 + ACC

### Accessories:

Catwalks, platforms and ladders, ventilation system, temperature and monitoring system, structure for TLS silos.



[www.simeza.com](http://www.simeza.com)

**SILOS METÁLICOS ZARAGOZA S.L.U.**

Autovía de Logroño, Km. 14,3

C/ Francia s/n

50180 Utebo (Saragossa)

Spain

T. +34 976 126 060

[simeza@simeza.com](mailto:simeza@simeza.com)



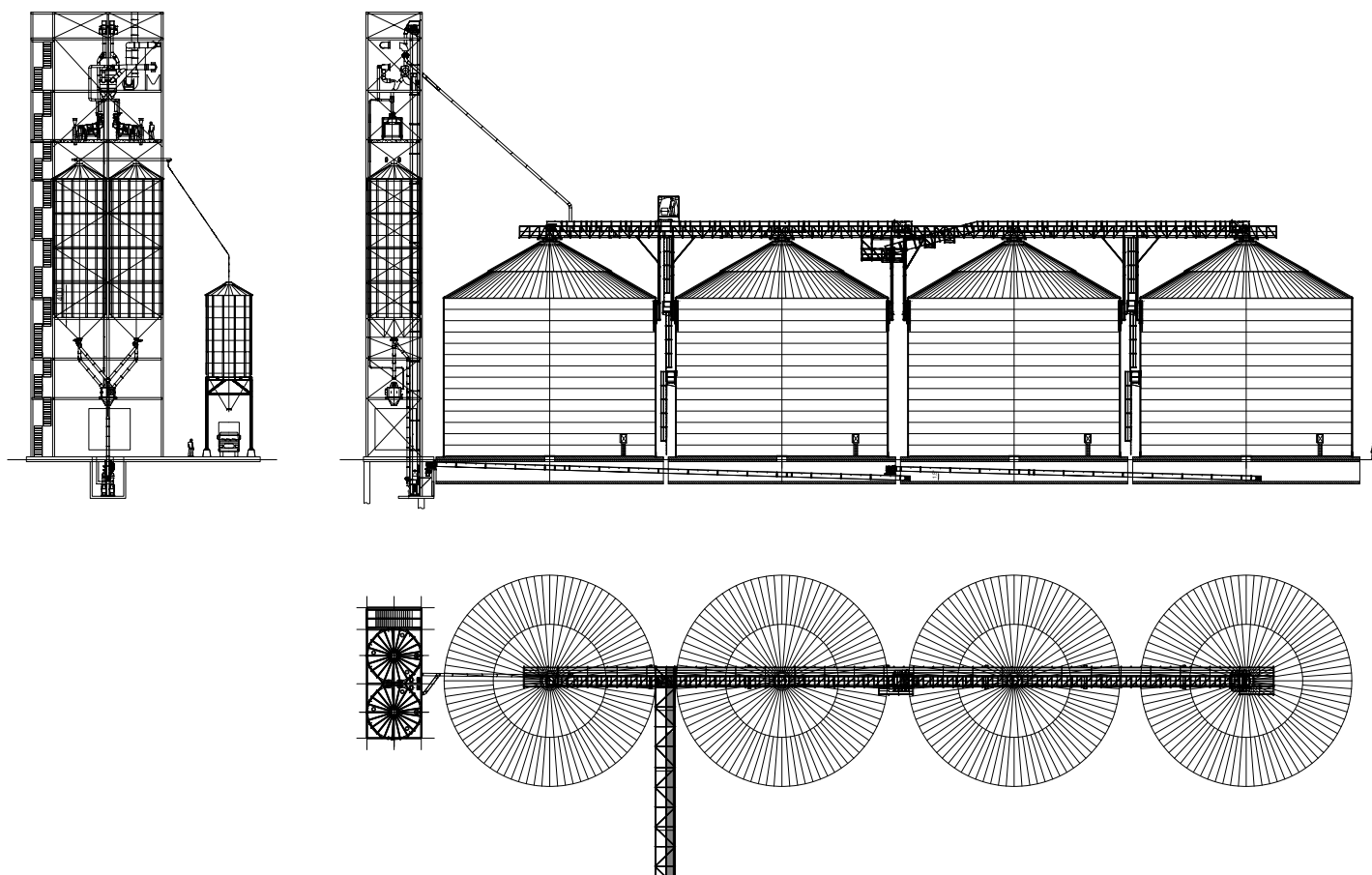

## Products

### Silos

- 4 Flat Bottom Silos FBS 21,40/14
- 2 Truck Loading Silos TLS-S 5,30/08/45
- 1 Truck Loading Silo TLS-S 4,60/07/60 + ACC

### Steel structures and accessories

- Catwalks
- Platforms and Ladders
- Ventilation system
- Temperature and monitoring system
- Structure for TLS silos

## Technical data

Type	FBS + TLS-S
Country	Saudi Arabia
City	Jeddah
Customer	Al Masirah Int. Ind. Investments Co LTD.
Description	Silo Plant for starch and glucose
Product	Wheat
Storage capacity t	20.000
Project partner	CESCO EPC GmbH
Year begin	2019
Year end	2020

## Services

Basic and Detail Engineering and design of the general layout and flow-chart of the storage area.

Design of architectural drawing for the civil works calculation and realization.

Steel structures design and static calculation.

## United Feed Company Saudi Arabia

Year: 2024

Product: Wheat and barley

Storage capacity: 215.000 t

### Location:

Jazan (Saudi Arabia)

### Number and type of Silos:

15 Flat Bottom Silos FBS 30,60/20

4 Truck Loading Silos TLS-S 5,30/05/45

2 Truck Loading Silos TLS-S 4,60/08/45

1 Truck Loading Silos TLS-S 4,60/07/60

4 Hopper Bottom Silos HBS-S 5,30/13/45

### Accessories:

Catwalks, Platforms and Ladders.



[www.simeza.com](http://www.simeza.com)

**SILOS METÁLICOS ZARAGOZA S.L.U.**

Autovía de Logroño, Km. 14,3

C/ Francia s/n

50180 Utebo (Saragossa)

Spain

T. +34 976 126 060

[simeza@simeza.com](mailto:simeza@simeza.com)





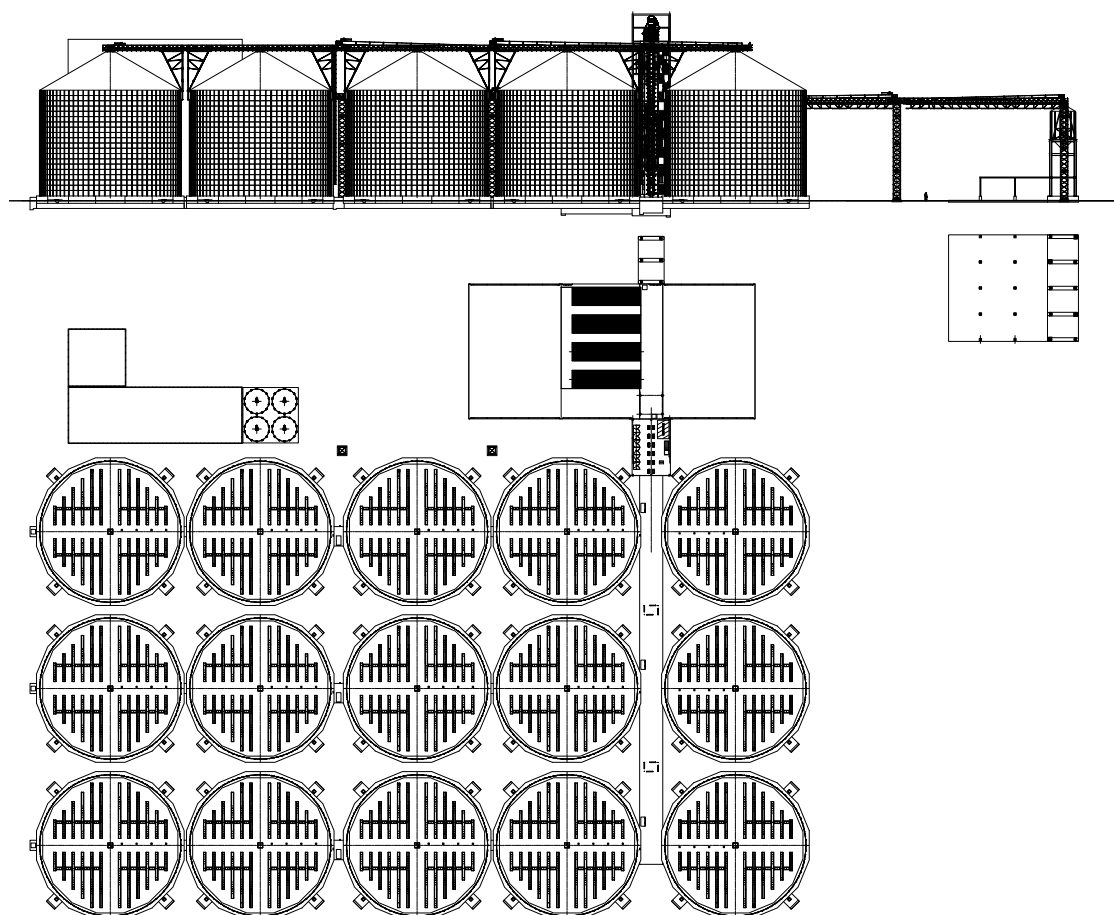

## Products

### Silos

- 15 Flat Bottom Silos FBS 30,60/20
- 4 Truck Loading Silos TLS-S 5,30/05/45
- 2 Truck Loading Silos TLS-S 4,60/08/45
- 1 Truck Loading Silos TLS-S 4,60/07/60
- 4 Hopper Bottom Silos HBS-S 5,30/13/45

### Steel structures and accessories

- Catwalks
- Platforms and Ladders

## Technical data

Type	FBS + TLS-S + HBS-S
Country	Saudi Arabia
City	Jazan
Customer	United Feed Company
Description	Storage silos for strategic port terminal
Product	Wheat and barley
Storage capacity t	215.000
Project partner	CESCO EPC GmbH
Year begin	2024
Year end	2025

## Services

Design of architectural drawing for the civil works calculation and realization.

Steel structures design and static calculation.



## Epicenter Shepetovka Ukraine

Year: 2020

Product: Wheat

Storage capacity: 136.500 t

### Location:

Rivne (Ukraine)

### Number and type of Silos:

12 Flat Bottom Silos FBS 27,50/18

12 Hopper Bottom Silos HBS-S 9,20/15/45

3 Truck Loading Silos TLS-S 4,60/04/45

### Accessories:

Catwalks, platforms and ladders, ventilation system, temperature and monitoring system, Pre lacquered roofs.



[www.simeza.com](http://www.simeza.com)

**SILOS METÁLICOS ZARAGOZA S.L.U.**

Autovía de Logroño, Km. 14,3

C/ Francia s/n

50180 Utebo (Saragossa)

Spain

T. +34 976 126 060

[simeza@simeza.com](mailto:simeza@simeza.com)



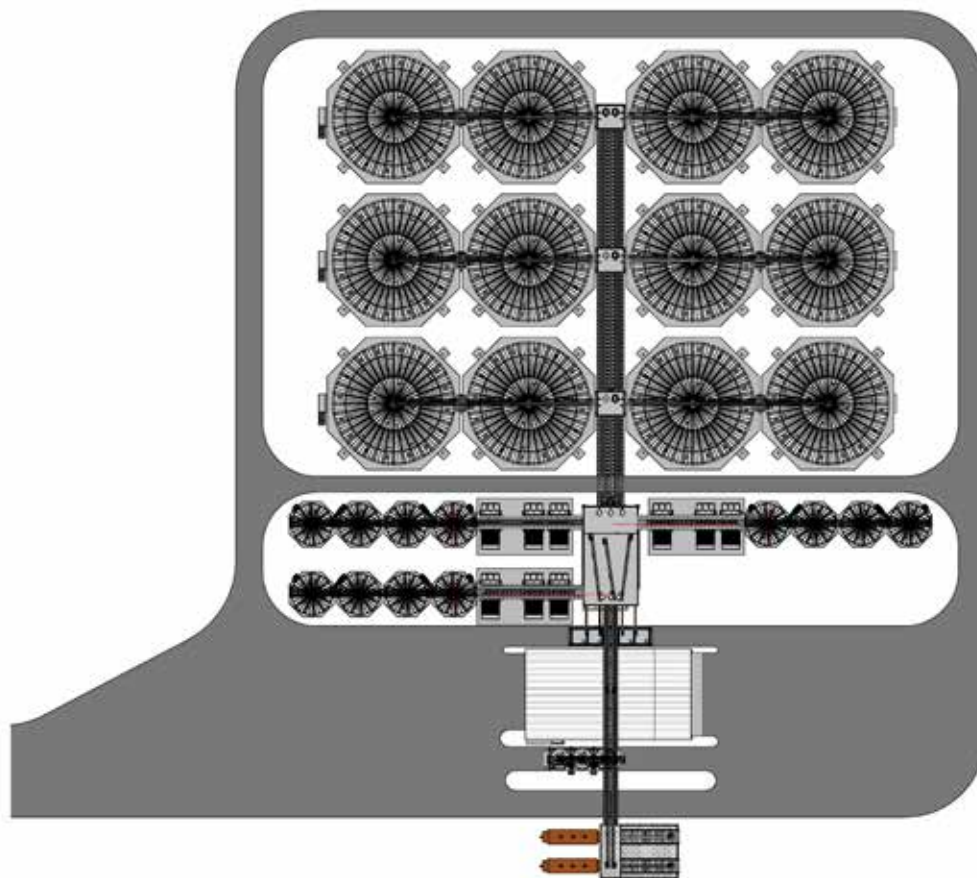

## Products

### Silos

- 12 Flat Bottom Silos FBS 27,50/18
- 12 Hopper Bottom Silos HBS-S 9,20/15/45
- 3 Truck Loading Silos TLS-S 4,60/04/45

### Steel structures and accessories

- Catwalks
- Platforms and Ladders
- Ventilation system
- Temperature and monitoring system
- Pre lacquered roofs

## Technical data

Type	FBS + HBS-S + TLS-S
Country	Ukraine
City	Rivne
Customer	Epicenter Shepetovka
Description	Storage Plant for wheat
Product	Wheat
Storage capacity t	136.500
Project partner	CESCO EPC GmbH
Year begin	2020
Year end	2021

## Services

Steel structures design and static calculation.





## TORNUM AB

### Latvia

Year: 2024

Product: Wheat

Storage capacity: 8.550 t

**Location:**

Madona (Latvia)

**Number and type of Silos:**

3 Flat Bottom Silos FBS 18,30/11

**Accessories:**

Catwalks, platforms and ladders, ventilation system.



[www.simeza.com](http://www.simeza.com)

**SILOS METÁLICOS ZARAGOZA S.L.U.**

Autovía de Logroño, Km. 14,3

C/ Francia s/n

50180 Utebo (Saragossa)

Spain

T. +34 976 126 060

[simeza@simeza.com](mailto:simeza@simeza.com)



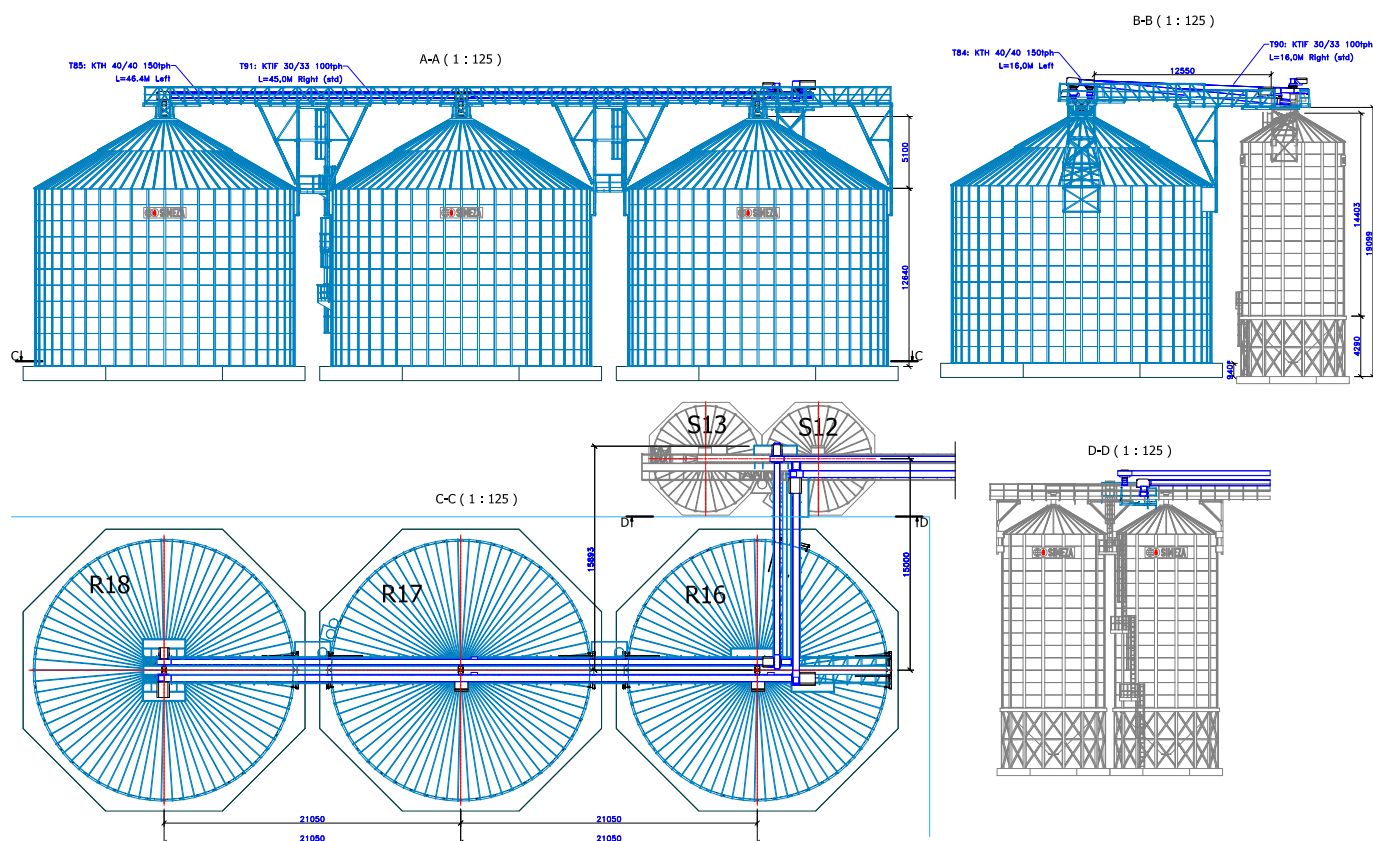

## Products

### Silos

- 3 Flat Bottom Silos FBS 18,30/11

### Steel structures and accessories

- Catwalks
- Platforms and Ladders
- Ventilation system

## Technical data

Type	FBS
Country	Latvia
City	Madona
Customer	TORNUM AB
Description	Storage plant for wheat
Product	Wheat
Storage capacity t	8.550
Project partner	TORNUM AB
Year begin	2024
Year end	2024

## Services

Basic and Detail Engineering and design of the general layout and flow-chart of the storage area.

Design of architectural drawing for the civil works calculation and realization.

Steel structures design and static calculation.



## **Société Camerounaise de Transformation de Blé (SCTB) Cameroon**

Year: 2022

Product: Wheat

Storage capacity: 20.000 t

**Location:**

Douala (Cameroon)

**Number and type of Silos:**

5 Flat Bottom Silos FBS 13,00/21

**Accessories:**

Catwalks, platforms and ladders, ventilation system.

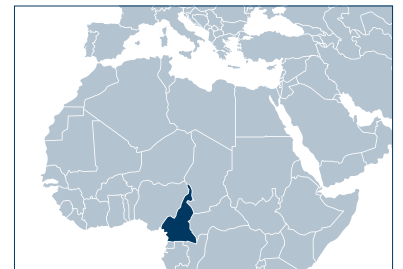

[www.simeza.com](http://www.simeza.com)

**SILOS METÁLICOS ZARAGOZA S.L.U.**

Autovía de Logroño, Km. 14,3

C/ Francia s/n

50180 Utebo (Saragossa)

Spain

T. +34 976 126 060

[simeza@simeza.com](mailto:simeza@simeza.com)





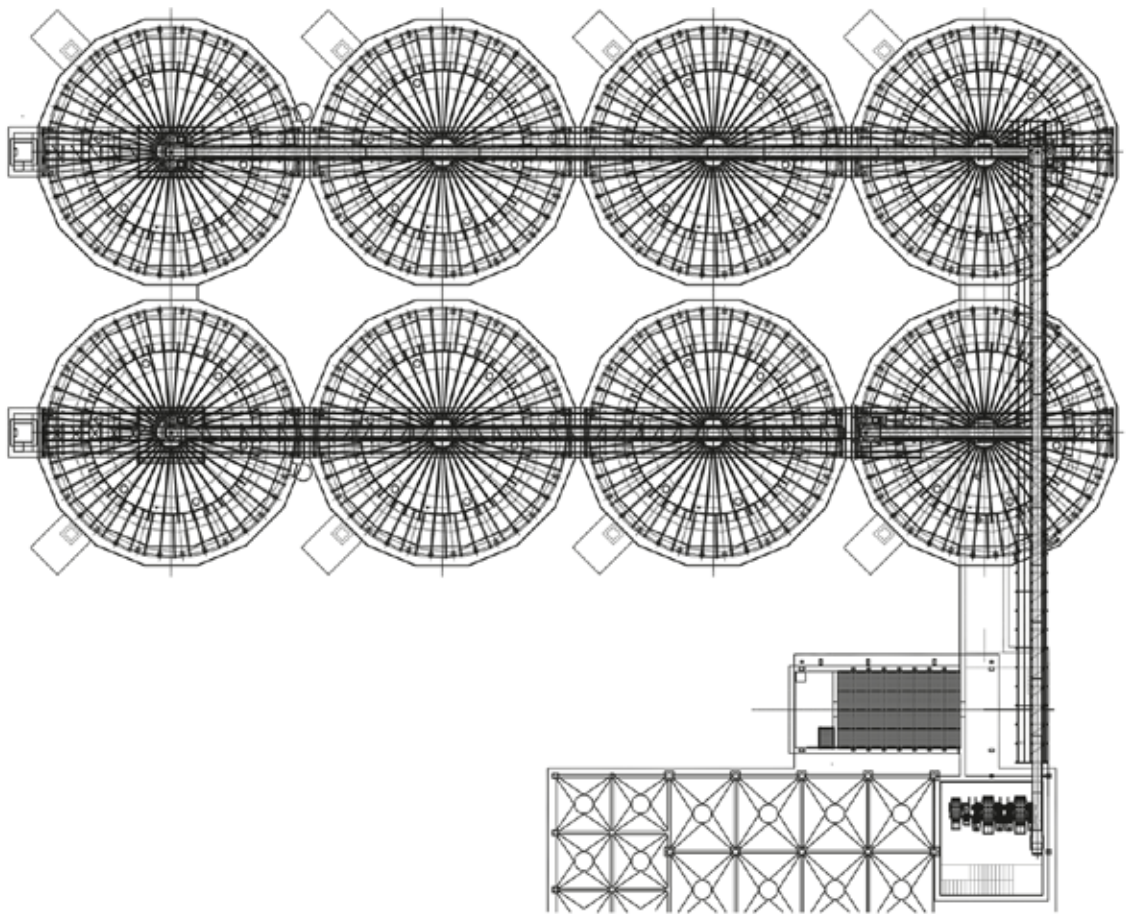

## Products

### Silos

- 5 Flat Bottom Silos FBS 13,00/21

### Steel structures and accessories

- Catwalks
- Platforms and Ladders
- Ventilation system

## Technical data

Type	FBS
Country	Cameroon
City	Douala
Customer	SCTB
Description	Storage silos for raw products
Product	Wheat
Storage capacity t	20.000
Project partner	CESCO EPC GmbH / CONVEX GmbH
Year begin	2022
Year end	2024

## Services

Steel structures design and static calculation.



## Agronom doo Croatia

Year: 2020

Product: Wheat

Storage capacity: 21.600 t

### Location:

Požega (Croatia)

### Number and type of Silos:

8 Flat Bottom Silos FBS 15,30/15

2 Hopper Bottom Silos HBS-S 6,90/15/45

### Accessories:

Platforms and ladders, ventilation system, temperature and monitoring system.



[www.simeza.com](http://www.simeza.com)

**SILOS METÁLICOS ZARAGOZA S.L.U.**

Autovía de Logroño, Km. 14,3

C/ Francia s/n

50180 Utebo (Saragossa)

Spain

T. +34 976 126 060

[simeza@simeza.com](mailto:simeza@simeza.com)



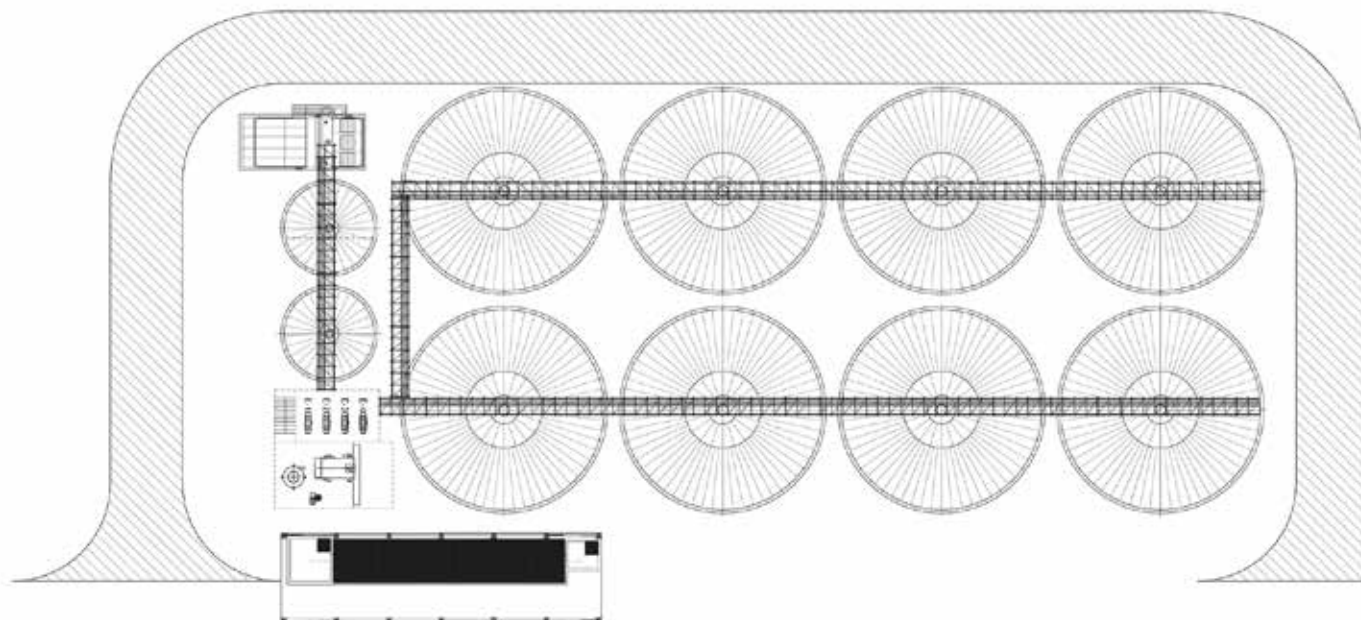

## Products

### Silos

- 8 Flat Bottom Silos FBS 15,30/15
- 2 Hopper Bottom Silos HBS-S 6,90/15/45

### Steel structures and accessories

- Platforms and Ladders
- Ventilation system
- Temperature and monitoring system

## Technical data

Type	FBS + HBS-S
Country	Croatia
City	Požega
Customer	Agronom doo
Description	Storage Plant for wheat
Product	Wheat
Storage capacity t	21.600
Project partner	CESCO EPC GmbH
Year begin	2020
Year end	2021

## Services

Basic and Detail Engineering and design of the general layout and flow-chart of the storage area.

Design of architectural drawing for the civil works calculation and realization.

Steel structures design and static calculation.





## Agriland Estonia

Year: 2021

Product: Wheat

Storage capacity: 19.000 t

### Location:

Jogeva (Estonia)

### Number and type of Silos:

6 Flat Bottom Silos FBS 16,80/15

1 Truck Loading Silos TLS 5,30/05/60

### Accessories:

Catwalks, platforms and ladders, ventilation system, structure for TLS silos.



[www.simeza.com](http://www.simeza.com)

**SILOS METÁLICOS ZARAGOZA S.L.U.**

Autovía de Logroño, Km. 14,3

C/ Francia s/n

50180 Utebo (Saragossa)

Spain

T. +34 976 126 060

[simeza@simeza.com](mailto:simeza@simeza.com)



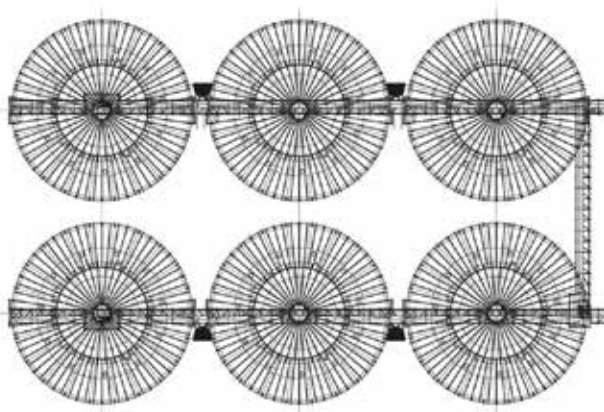
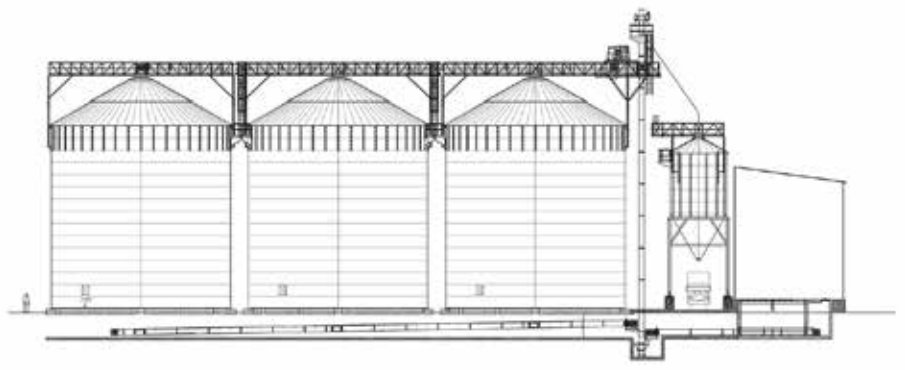
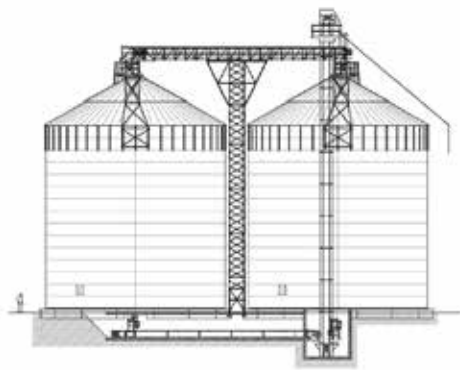

## Products

### Silos

- 6 Flat Bottom Silos FBS 16,80/15
- 1 Truck Loading Silos TLS 5,30/05/60

### Steel structures and accessories

- Catwalks
- Platforms and Ladders
- Ventilation system
- Structure for TLS silos

## Technical data

Type	FBS + TLS
Country	Estonia
City	Jogeva
Customer	Agriland
Description	Storage Plant for wheat
Product	Wheat
Storage capacity t	19.000
Project partner	CESCO EPC GmbH
Year begin	2021
Year end	2022

## Services

Basic and Detail Engineering and design of the general layout and flow-chart of the storage area.

Design of architectural drawing for the civil works calculation and realization.

Steel structures design and static calculation.



## Technobins Italy

Year: 2021

Product: Wheat

Storage capacity: 4.500 t

### Location:

Troia (Italy)

### Number and type of Silos:

4 Flat Bottom Silos FBS 10,70/12

2 Hopper Bottom Silos HBS-S 5,30/09/45

### Accessories:

Catwalks, platforms and ladders.



[www.simeza.com](http://www.simeza.com)

**SILOS METÁLICOS ZARAGOZA S.L.U.**

Autovía de Logroño, Km. 14,3

C/ Francia s/n

50180 Utebo (Saragossa)

Spain

T. +34 976 126 060

[simeza@simeza.com](mailto:simeza@simeza.com)





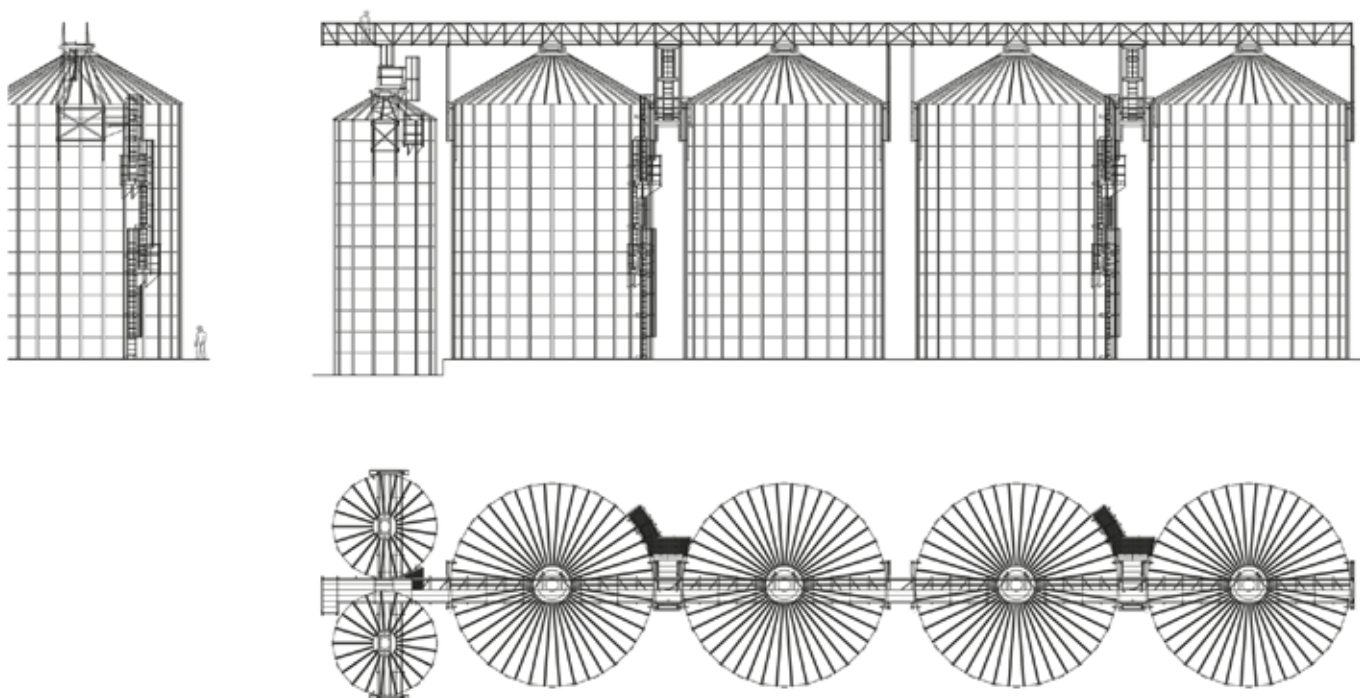

## Products

### Silos

- 4 Flat Bottom Silos FBS 10,70/12
- 2 Hopper Bottom Silos HBS-S 5,30/09/45

### Steel structures and accessories

- Catwalks
- Platforms and Ladders

## Technical data

Type	FBS + HBS-S
Country	Italy
City	Troia
Customer	Technobins
Description	Storage Plant for wheat
Product	Wheat
Storage capacity t	4.500
Project partner	-
Year begin	2021
Year end	2023

## Services

Basic and Detail Engineering and design of the general layout and flow-chart of the storage area.

Design of architectural drawing for the civil works calculation and realization.

Steel structures design and static calculation.



## Costruzioni Meccaniche Visentin Italy

Year: 2023

Product: Wheat

Storage capacity: 6.400 t

**Location:**

Ravenna (Italy)

**Number and type of Silos:**

6 Flat Bottom Silos FBS 11,50/11

**Accessories:**

Catwalks, platforms and ladders.



[www.simeza.com](http://www.simeza.com)

**SILOS METÁLICOS ZARAGOZA S.L.U.**

Autovía de Logroño, Km. 14,3

C/ Francia s/n

50180 Utebo (Saragossa)

Spain

T. +34 976 126 060

[simeza@simeza.com](mailto:simeza@simeza.com)



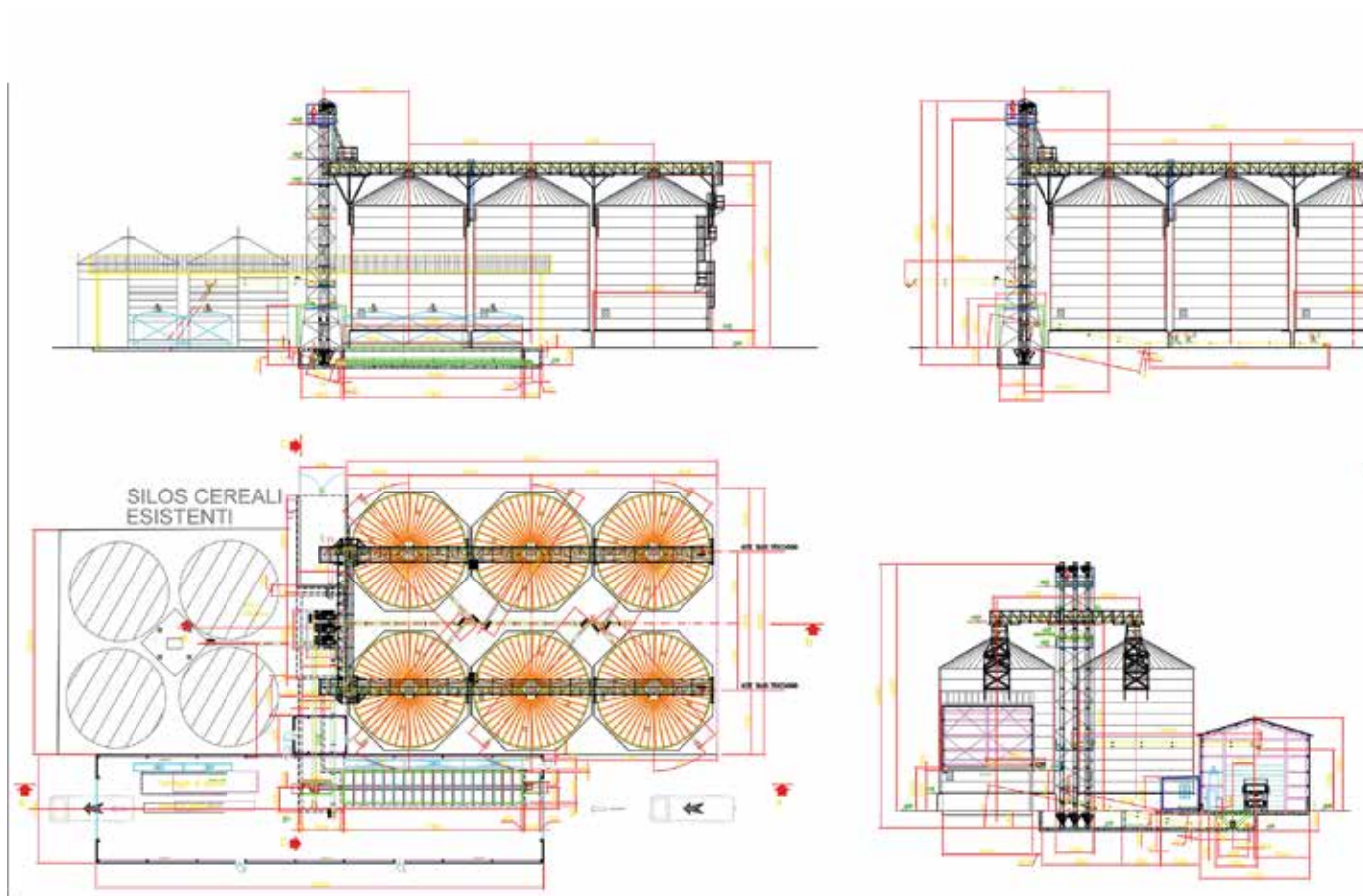

## Products

### Silos

- 6 Flat Bottom Silos FBS 11,50/11

### Steel structures and accessories

- Catwalks
- Platforms and Ladders

## Technical data

Type	FBS
Country	Italy
City	Ravenna
Customer	Costruzioni Meccaniche Visentin
Description	Storage Plant for wheat
Product	Wheat
Storage capacity t	6,400
Project partner	CESCO EPC
Year begin	2023
Year end	2024

## Services

Basic and Detail Engineering and design of the general layout and flow-chart of the storage area.

Design of architectural drawing for the civil works calculation and realization.

Steel structures design and static calculation.





## Bakex Millers Ltd. Kenya

Year: 2017

Product: Corn

Storage capacity: 12.600 t

### Location:

Thika (Kenya)

### Number and type of Silos:

6 Flat Bottom Silos FBS 16,80/18

1 Flat Bottom Silos FBS 13,80/18

2 Hopper Bottom Silos HBS 13,80/18/45

### Accessories:

Catwalks, platforms and ladders, ventilation system, temperature and monitoring system.



[www.simeza.com](http://www.simeza.com)

**SILOS METÁLICOS ZARAGOZA S.L.U.**

Autovía de Logroño, Km. 14,3

C/ Francia s/n

50180 Utebo (Saragossa)

Spain

T. +34 976 126 060

[simeza@simeza.com](mailto:simeza@simeza.com)



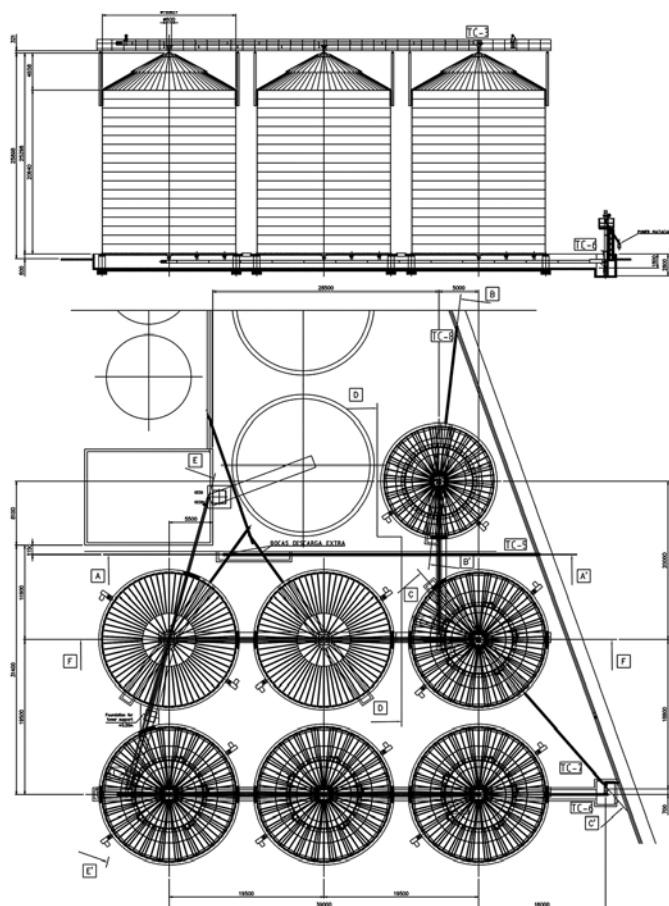

## Products

### Silos

- 6 Flat Bottom Silos FBS 16,80/18
- 1 Flat Bottom Silos FBS 13,80/18
- 2 Hopper Bottom Silos HBS 13,80/18/45

### Steel structures and accessories

- Catwalks
- Platforms and Ladders
- Ventilation system
- Temperature and Monitoring system

## Technical data

Type	FBS + HBS
Country	Kenya
City	Thika
Customer	Bakex Millers Ltd.
Description	Storage Plant for corn
Product	Corn
Storage capacity t	12.600
Project partner	-
Year begin	2017
Year end	2018

## Services

Basic and Detail Engineering and design of the general layout and flow-chart of the storage area.

Design of architectural drawing for the civil works calculation and realization.

Steel structures design and static calculation.



## Aviagro Mozambique

Year: 2016

Product: Corn

Storage capacity: 30.000 t

### Location:

Chimoio (Mozambique)

### Number and type of Silos:

30 Flat Bottom Silos FBS 10,70/12

### Accessories:

Catwalks, platforms and ladders, ventilation system.



[www.simeza.com](http://www.simeza.com)

**SILOS METÁLICOS ZARAGOZA S.L.U.**

Autovía de Logroño, Km. 14,3

C/ Francia s/n

50180 Utebo (Saragossa)

Spain

T. +34 976 126 060

[simeza@simeza.com](mailto:simeza@simeza.com)





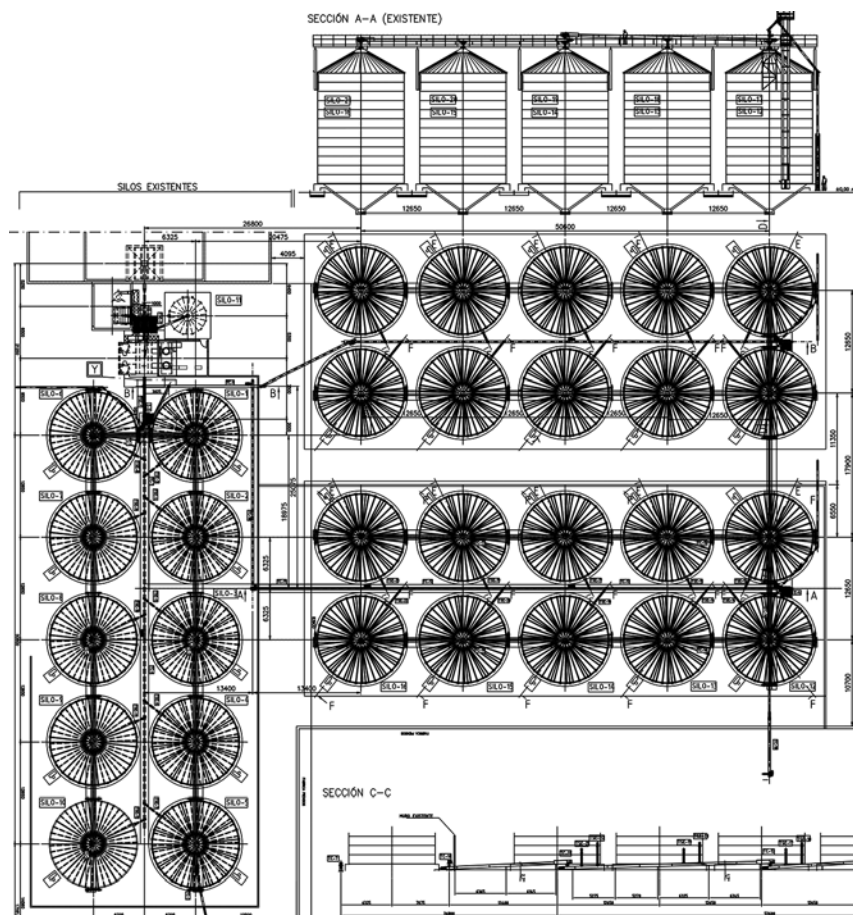

## Products

### Silos

- 30 Flat Bottom Silos FBS 10,70/12

### Steel structures and accessories

- Catwalks
- Platforms and Ladders
- Ventilation system

## Technical data

Type	FBS
Country	Mozambique
City	Chimoio
Customer	Aviagro
Description	Storage Plant for wheat
Product	Corn for feed mill poultry factory
Storage capacity t	30.000
Project partner	-
Year begin	2016
Year end	2019

## Services

Basic and Detail Engineering and design of the general layout and flow-chart of the storage area of the plants.

Design of architectural drawing for the civil works calculation and realization.

Steel structures design and static calculation.

Delivery of all the silos and accessories.

Supervision.

Commissioning.

# Hopper Bottom Silos

**(HBS)**





## **CESCO EPC GmbH**

### **Sweden**

Year: 2021

Product: Oat

Storage capacity: 700 t

**Location:**

Kimstad (Sweden)

**Number and type of Silos:**

4 Hopper Bottom Silos HBS-S 4,60/14/45

**Accessories:**

Roof ladder, vertical ladder, tunnel walkway, cone discharge with MFAK-200  
BUHLER, radar level, snow avalanche system.

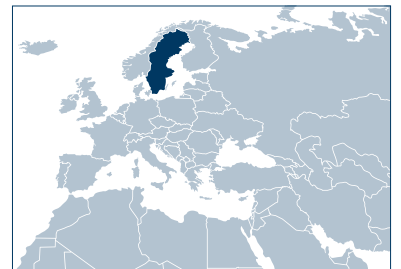

[www.simeza.com](http://www.simeza.com)

**SILOS METÁLICOS ZARAGOZA S.L.U.**

Autovía de Logroño, Km. 14,3

C/ Francia s/n

50180 Utebo (Saragossa)

Spain

T. +34 976 126 060

[simeza@simeza.com](mailto:simeza@simeza.com)





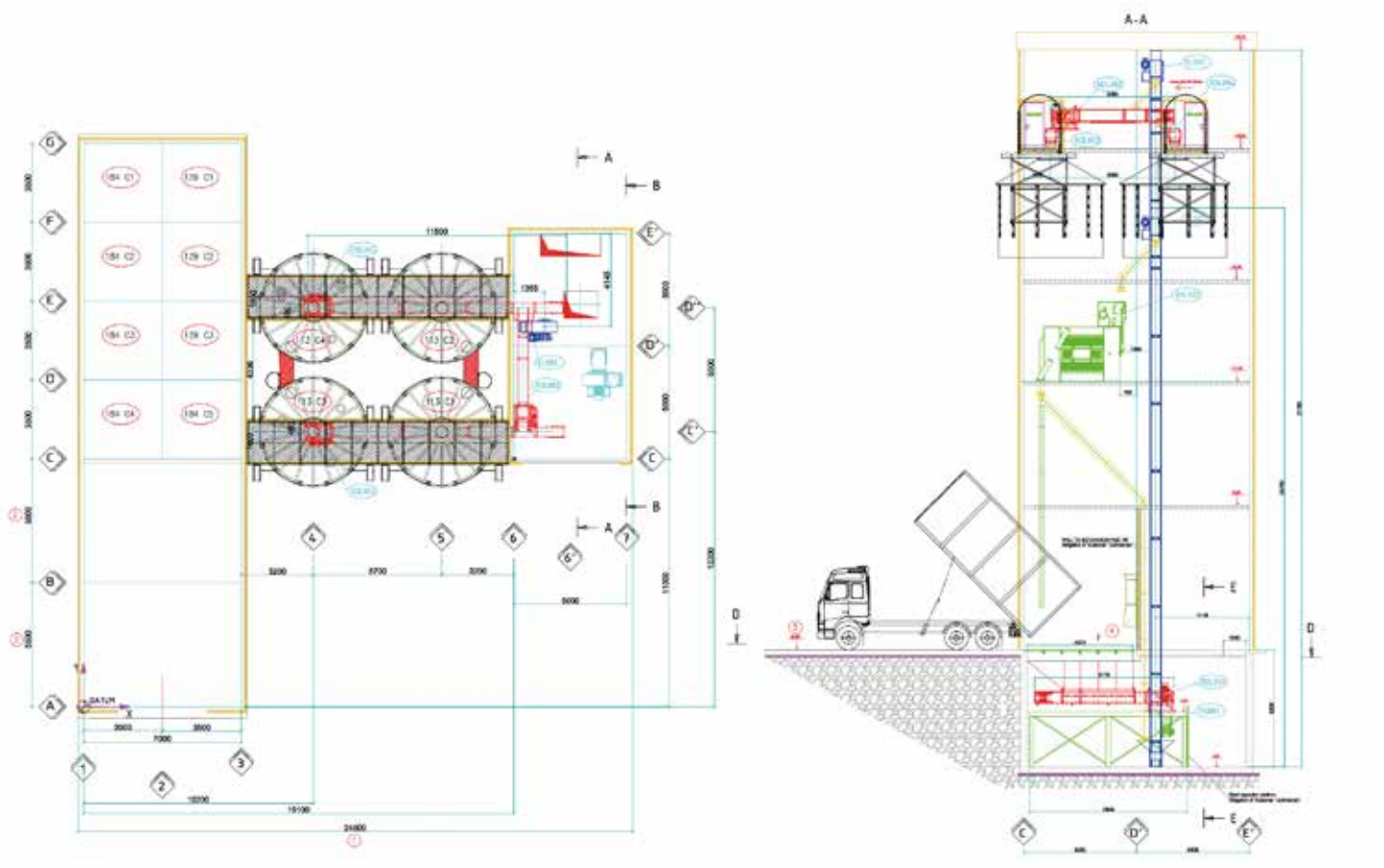

## Products

### Silos

- 4 Hopper Bottom Silos HBS-S 4,60/14/45

### Steel structures and accessories

- Roof ladder
- Vertical ladder
- Tunnel walkway
- Cone discharge with MFAK-200 BUHLER
- Radar level
- Snow avalanche system

## Technical data

Type	HBS-S
Country	Sweden
City	Kimstad
Customer	CESCO EPC GmbH
Description	Round silos for raw material and finished product
Product	Oat
Storage capacity t	700
Project partner	CESCO EPC GmbH
Year begin	2021
Year end	2022

## Services

Delivery and supervision of installation of the silo plant and steel structures related to the silo.



## La Zaragozana Brewery Spain

Year: 2017

Product: Malt, corn grit, rice

Storage capacity: 3.400 t

### Location:

Zaragoza (Spain)

### Number and type of Silos:

4 Hopper Bottom Silos HBS-S 3,60/20/65

2 Hopper Bottom Silos HBS-S 6,10/25/60

4 Hopper Bottom Silos HBS-S 6,10/25/45

### Accessories:

Roof ladder, vertical ladder, catwalks, unloading in 60° cone silos MFVH-180  
BUHLER, radar level, cleaning filter MVRW-9/12 BUHLER.

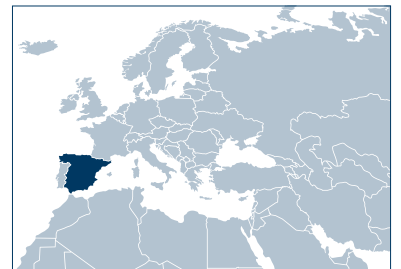

[www.simeza.com](http://www.simeza.com)

**SILOS METÁLICOS ZARAGOZA S.L.U.**

Autovía de Logroño, Km. 14,3

C/ Francia s/n

50180 Utebo (Saragossa)

Spain

T. +34 976 126 060

[simeza@simeza.com](mailto:simeza@simeza.com)









## **PETKUS España** **Spain**

**Year:** 2016

**Product:** Legumes, peas

**Storage capacity:** 1.750 t

**Location:**

Magaz de Pisuerga, Palencia (Spain)

**Number and type of Silos:**

6 Hopper Bottom Silos HBS 5,30/14/45

**Accessories:**

Roof ladder, vertical ladder, grain drop speed reducer, Aeration system.

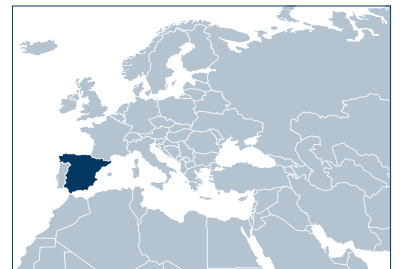

[www.simeza.com](http://www.simeza.com)

**SILOS METÁLICOS ZARAGOZA S.L.U.**

Autovía de Logroño, Km. 14,3

C/ Francia s/n

50180 Utebo (Saragossa)

Spain

T. +34 976 126 060

[simeza@simeza.com](mailto:simeza@simeza.com)



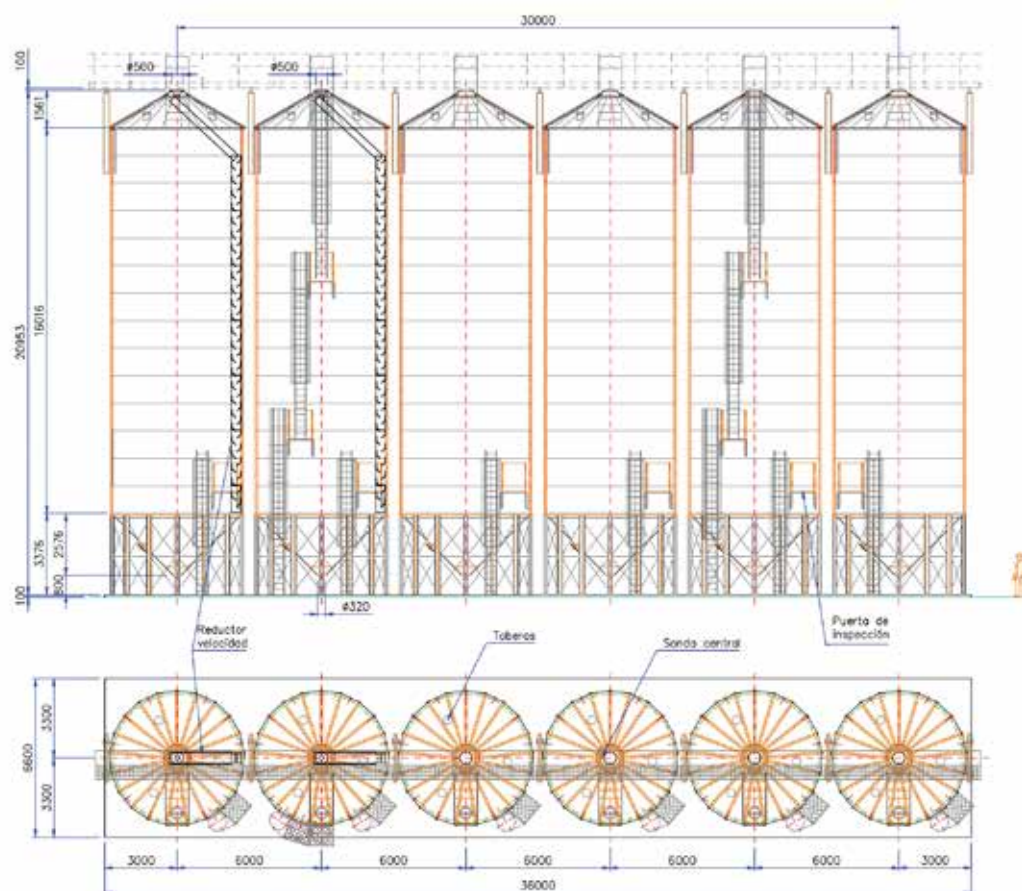

## Products

### Silos

- 6 Hopper Bottom Silos HBS 5,30/14/45

### Steel structures and accessories

- Roof ladder
- Vertical ladder
- Grain drop speed reducer
- Aeration system

## Technical data

Type	HBS
Country	Spain
City	Magaz de Pisuerga, Palencia
Customer	PETKUS España S.L.
Description	Round silos for raw material and finished product
Product	Legumes, peas
Storage capacity t	1.750
Project partner	PETKUS España
Year begin	2016
Year end	2016

## Services

Delivery and supervision of installation of the silo plant and steel structures related to the silo.  
Commissioning.



## Agrovecó Spain

Year: 2012

Product: Corn

Storage capacity: 8.000 t

### Location:

Casetas, Zaragoza (Spain)

### Number and type of Silos:

10 Hopper Bottom Silos HBS 9,20/12/45

### Accessories:

Roof ladder, vertical ladder, tunnel catwalk, cone ventilation system.

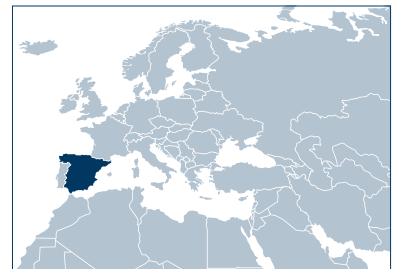

[www.simeza.com](http://www.simeza.com)

**SILOS METÁLICOS ZARAGOZA S.L.U.**

Autovía de Logroño, Km. 14,3

C/ Francia s/n

50180 Utebo (Saragossa)

Spain

T. +34 976 126 060

[simeza@simeza.com](mailto:simeza@simeza.com)





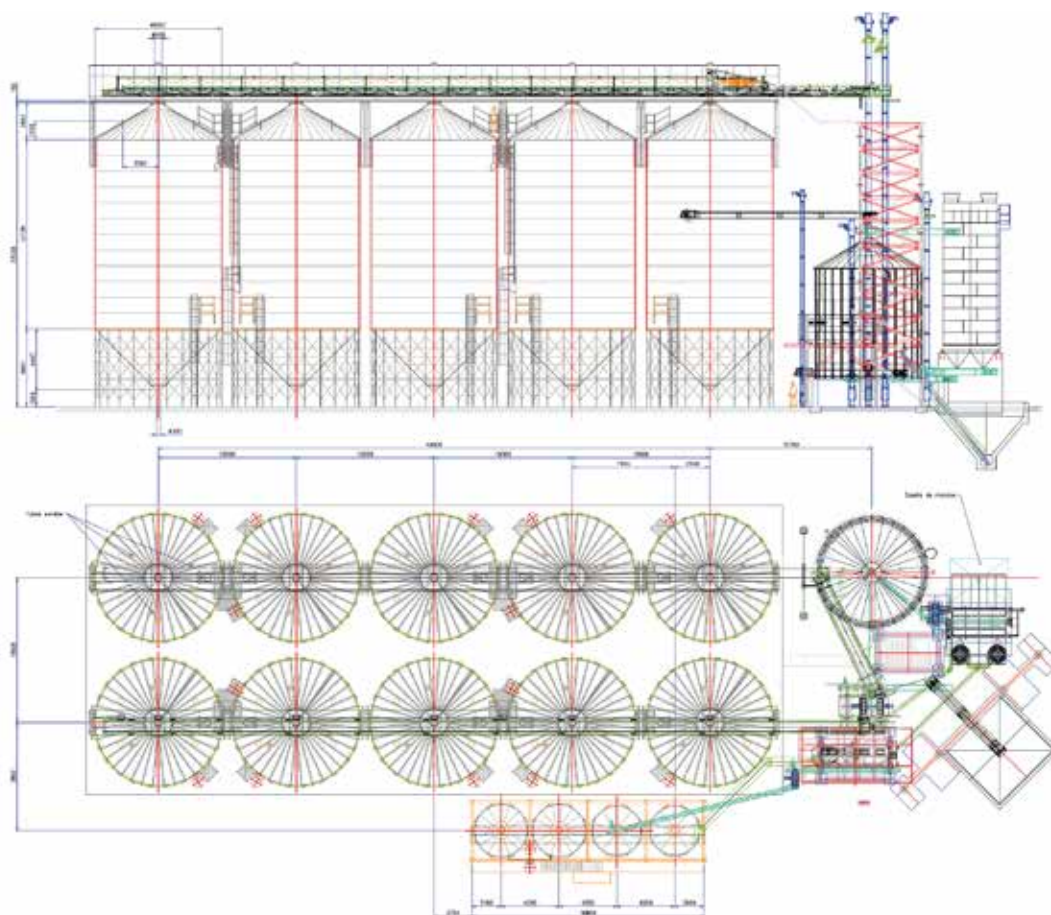

## Products

### Silos

- 10 Hopper Bottom Silos HBS-9,20/12/45

### Steel structures and accessories

- Roof ladder
- Vertical ladder
- Tunnel catwalk
- Cone ventilation system

## Technical data

Type	HBS
Country	Spain
City	Casetas, Zaragoza
Customer	Agrovecó
Description	Round silos for non-GM corn for human consumption
Product	Corn
Storage capacity t	8.000
Project partner	Agrovecó
Year begin	2012
Year end	2012

## Services

Delivery and supervision of installation of the silo plant and steel structures related to the silo.

Commissioning.



## Coavre Spain

Year: 2022

Product: Wheat

Storage capacity: 700 t

### Location:

Silla, Valencia (Spain)

### Number and type of Silos:

1 Hopper Bottom Silo HBS 7,60/16/45

### Accessories:

Level indicator, walkways, platform, ladders, roof perimeter railing, aeration system.



[www.simeza.com](http://www.simeza.com)

**SILOS METÁLICOS ZARAGOZA S.L.U.**

Autovía de Logroño, Km. 14,3

C/ Francia s/n

50180 Utebo (Saragossa)

Spain

T. +34 976 126 060

[simeza@simeza.com](mailto:simeza@simeza.com)









## Ribeiros Cereais Portugal

Year: 2021

Product: Wheat

Storage capacity: 1.800 t

### Location:

Montijo (Portugal)

### Number and type of Silos:

20 Hopper Bottom Silos HBS 3,10/08/45

4 Hopper Bottom Silos HBS 4,60/11/45

### Accessories:

Level sensors, ladders, supports, walkways.



[www.simeza.com](http://www.simeza.com)

**SILOS METÁLICOS ZARAGOZA S.L.U.**

Autovía de Logroño, Km. 14,3

C/ Francia s/n

50180 Utebo (Saragossa)

Spain

T. +34 976 126 060

[simeza@simeza.com](mailto:simeza@simeza.com)



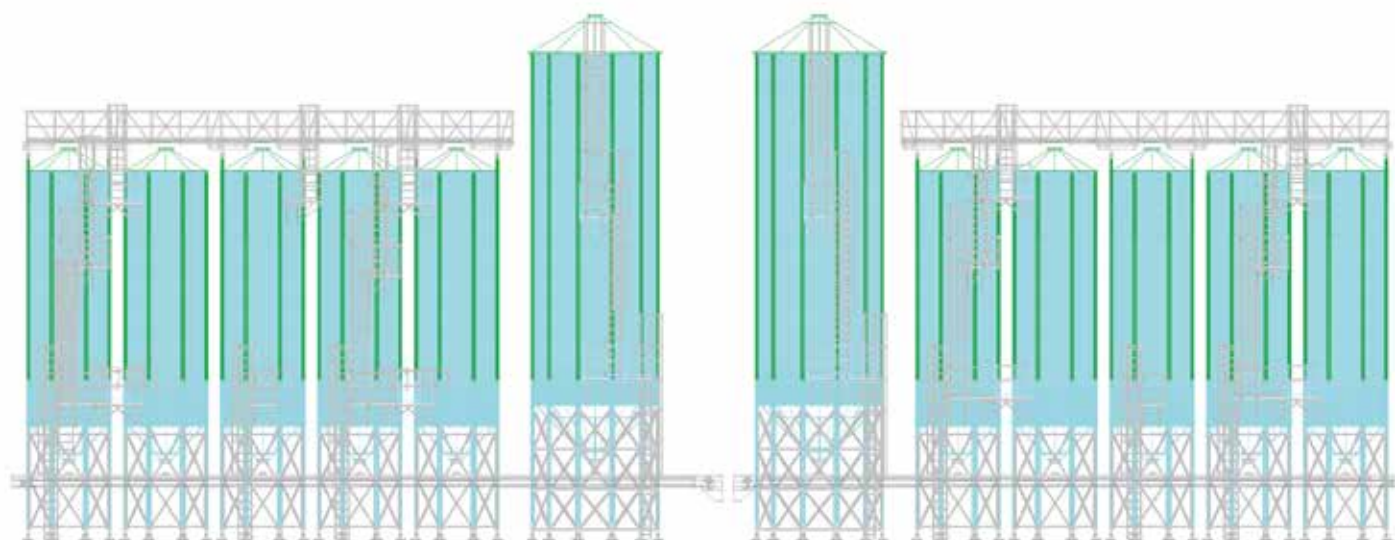

## Products

### Silos

- 20 Hopper Bottom Silos HBS 3,10/08/45
- 4 Hopper Bottom Silos HBS 4,60/11/45

### Steel structures and accessories

- Level sensors
- Ladders
- Supports
- Walkways

## Technical data

Type	HBS
Country	Portugal
City	Montijo
Customer	Ribeiros Cereais
Description	Storage plant for wheat
Product	Wheat
Storage capacity t	1.800
Project partner	PETKUS España S.L.
Year begin	2021
Year end	2022

## Services

Delivery.  
Commissioning.



## Amorditerra Societa Cooperativa Italy

Year: 2020

Product: Wheat

Storage capacity: 850 t

### Location:

Foggia (Italy)

### Number and type of Silos:

1 Hopper Bottom Silo HBS-S 7,60/09/45

4 Hopper Bottom Silos HBS-S 3,80/10/45

### Accessories:

Maximum and minimum level, temperature system, aeration system, grain fall reducer, stairs and platforms, catwalks.



[www.simeza.com](http://www.simeza.com)

**SILOS METÁLICOS ZARAGOZA S.L.U.**

Autovía de Logroño, Km. 14,3

C/ Francia s/n

50180 Utebo (Saragossa)

Spain

T. +34 976 126 060

[simeza@simeza.com](mailto:simeza@simeza.com)





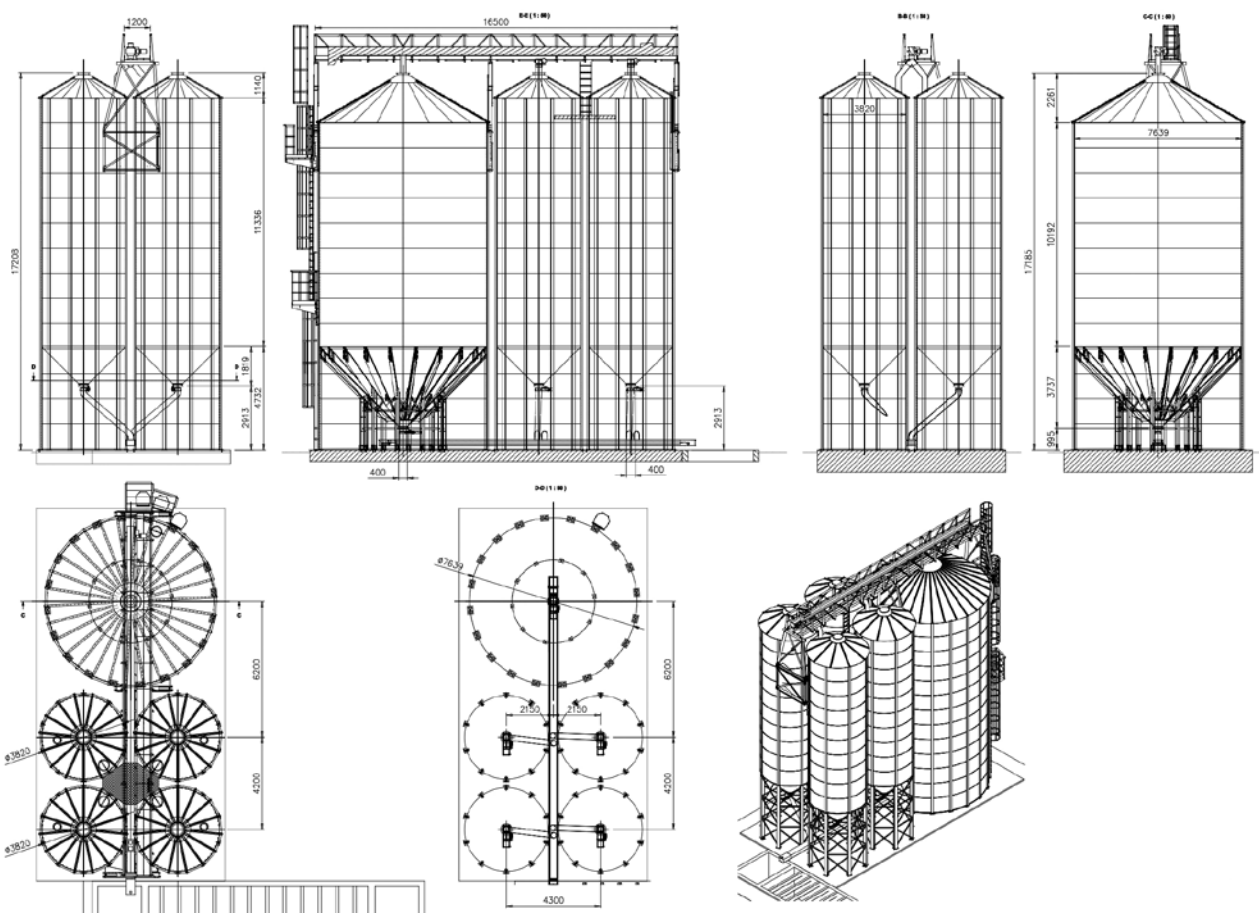

## Products

### Silos

- 1 Hopper Bottom Silo HBS-S 7,60/09/45
- 4 Hopper Bottom Silos HBS-S 3,80/10/45

### Steel structures and accessories

- Maximum and minimum level
- Temperature system
- Aeration system
- Grain fall reducer
- Stairs and platforms
- Catwalks

## Technical data

Type	HBS-S
Country	Italy
City	Foggia
Customer	Amorditerra Societa Cooperativa
Description	Storage plant for wheat
Product	Wheat
Storage capacity t	850
Project partner	Technobins
Year begin	2020
Year end	2021

## Services

Basic and Detail Engineering and design of the general layout and flow-chart of the storage area of the plants.

Design of architectural drawing for the civil works calculation and realization.

Steel structures design and static calculation.

Delivery of the silo plant and metallic structures.



## La Sanfermese Spa Italy

Year: 2019

Product: Soya

Storage capacity: 4.500 t

**Location:**

Mantova

**Number and type of Silos:**

4 Hopper Bottom Silos HBS-S 9,90/15/45

**Accessories:**

Roof ladder, vertical ladder, special fumigation roof.



[www.simeza.com](http://www.simeza.com)

**SILOS METÁLICOS ZARAGOZA S.L.U.**

Autovía de Logroño, Km. 14,3

C/ Francia s/n

50180 Utebo (Saragossa)

Spain

T. +34 976 126 060

[simeza@simeza.com](mailto:simeza@simeza.com)



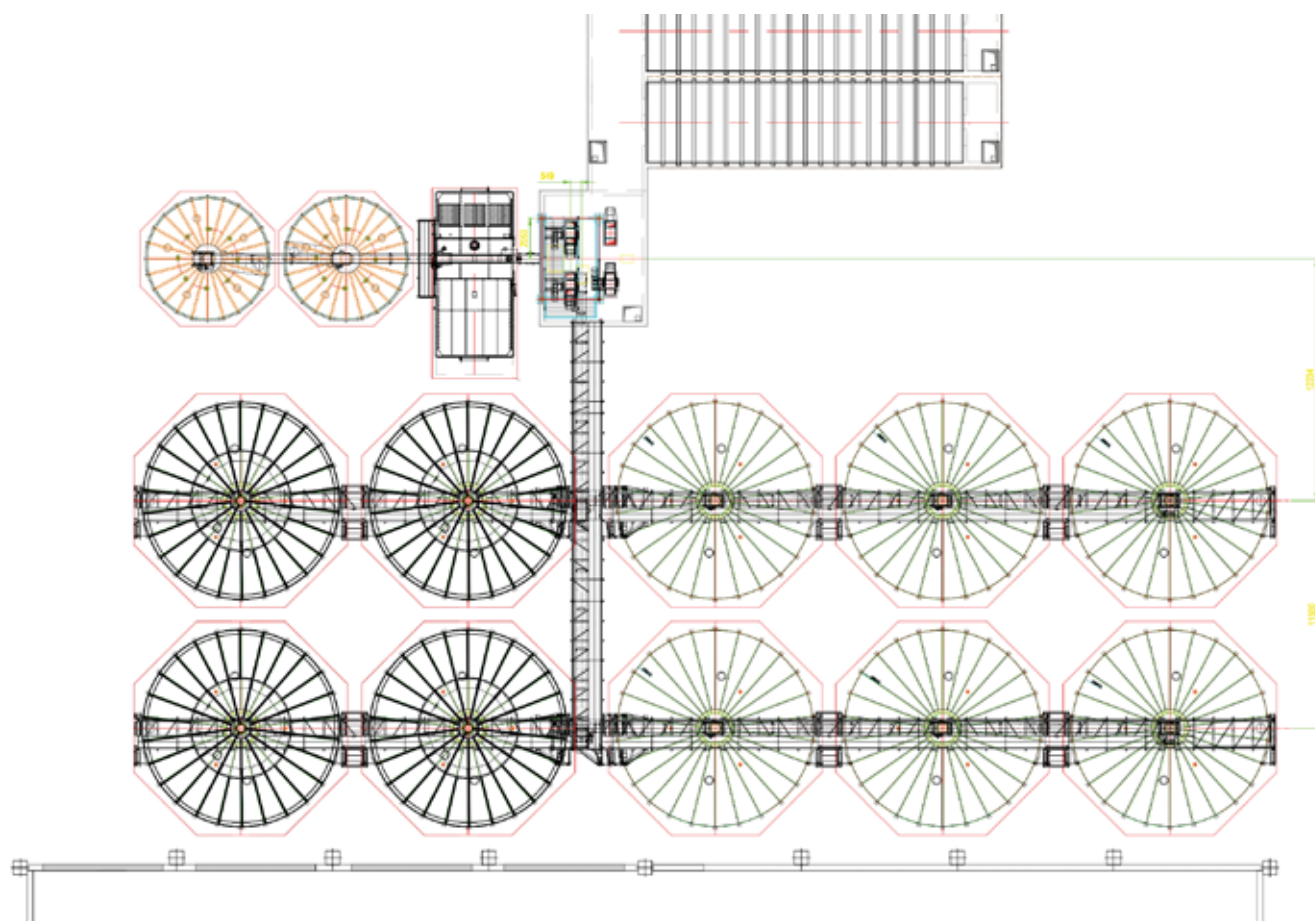

## Products

### Silos

- 4 Hopper Bottom Silos HBS-S 9,90/15/45

### Steel structures and accessories

- Roof ladder
- Vertical ladder
- Special fumigation roof

## Technical data

Type	HBS-S
Country	Italy
City	Mantova
Customer	La Sanfermese Spa
Description	Storage plant for wheat
Product	Soya
Storage capacity t	4.500
Project partner	CESCO EPC
Year begin	2019
Year end	2020

## Services

Basic and Detail Engineering and design of the general layout and flow-chart of the storage area of the plants.

Design of architectural drawing for the civil works calculation and realization.

Steel structures design and static calculation.

Delivery of the silo plant and metallic structures.





## **PETKUS Asia Ltd.** **Cambodia**

**Year:** 2019

**Product:** Rice

**Storage capacity:** 5.000 t

**Location:**

Battembang (Camboya)

**Number and type of Silos:**

20 Hopper Bottom Silos HBS-S 5,30/11/45

4 Hopper Bottom Silos HBS-S 4,60/05/45

**Accessories:**

Catwalks, platforms and ladders.



[www.simeza.com](http://www.simeza.com)

**SILOS METÁLICOS ZARAGOZA S.L.U.**

Autovía de Logroño, Km. 14,3

C/ Francia s/n

50180 Utebo (Saragossa)

Spain

T. +34 976 126 060

[simeza@simeza.com](mailto:simeza@simeza.com)



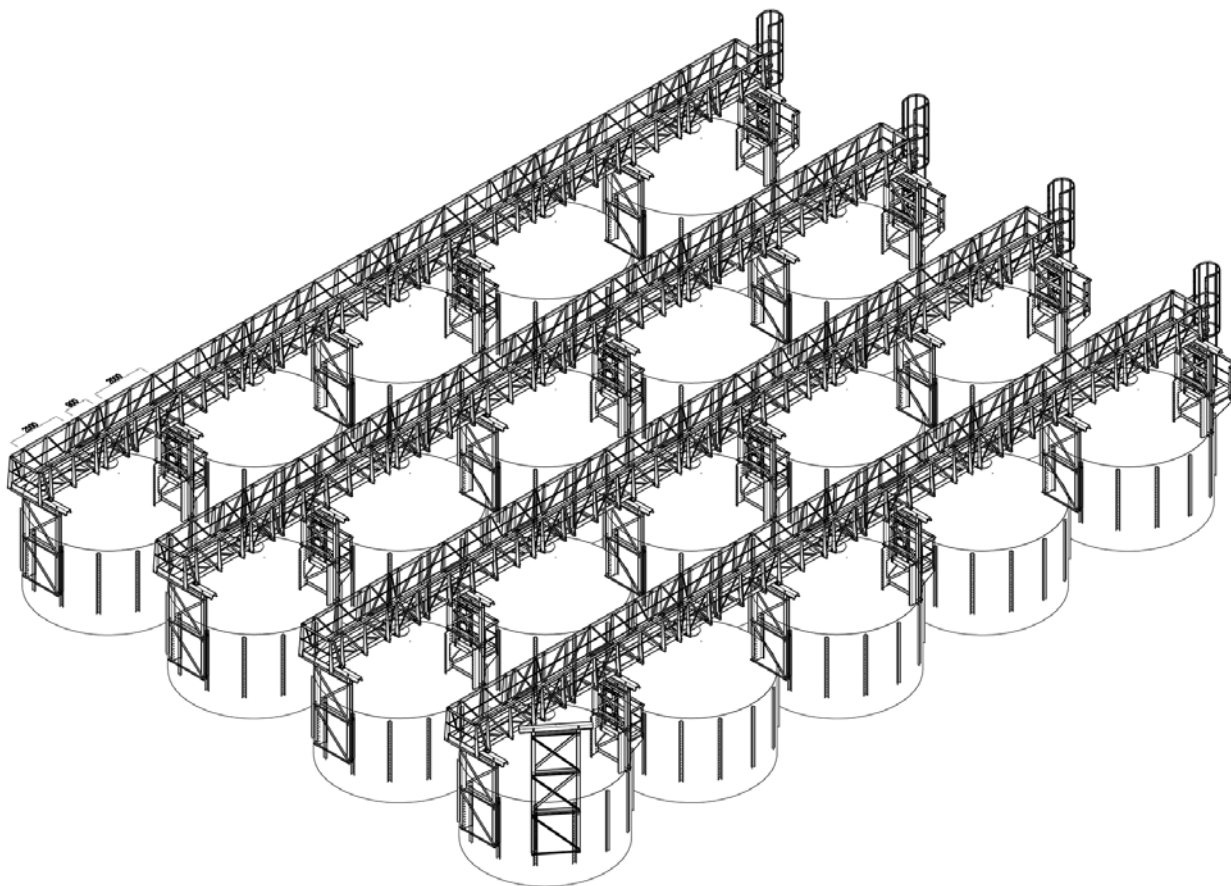

## Products

### Silos

- 20 Hopper Bottom Silos HBS-S 5,30/11/45
- 4 Hopper Bottom Silos HBS-S 4,60/05/45

### Steel structures and accessories

- Catwalks
- Platforms and Ladders

## Technical data

Type	HBS-S
Country	Camboya
City	Battambang
Customer	PETKUS Asia Ltd.
Description	Storage plant for rice (indoor)
Product	Rice
Storage capacity t	5.000
Project partner	PETKUS Asia Ltd.
Year begin	2019
Year end	2020

## Services

Basic and Detail Engineering and design of the general layout and flow-chart of the storage area of the plants.

Design of architectural drawing for the civil works calculation and realization.

Steel structures design and static calculation.



## Indofood Philippines

Year: 2019

Product: Wheat

Storage capacity: 1.500 t

### Location:

Manila (Filipinas)

### Number and type of Silos:

3 Hopper Bottom Silos HBS 6,90/14/45

### Accessories:

Catwalks, platforms and ladders.



[www.simeza.com](http://www.simeza.com)

**SILOS METÁLICOS ZARAGOZA S.L.U.**

Autovía de Logroño, Km. 14,3

C/ Francia s/n

50180 Utebo (Saragossa)

Spain

T. +34 976 126 060

[simeza@simeza.com](mailto:simeza@simeza.com)





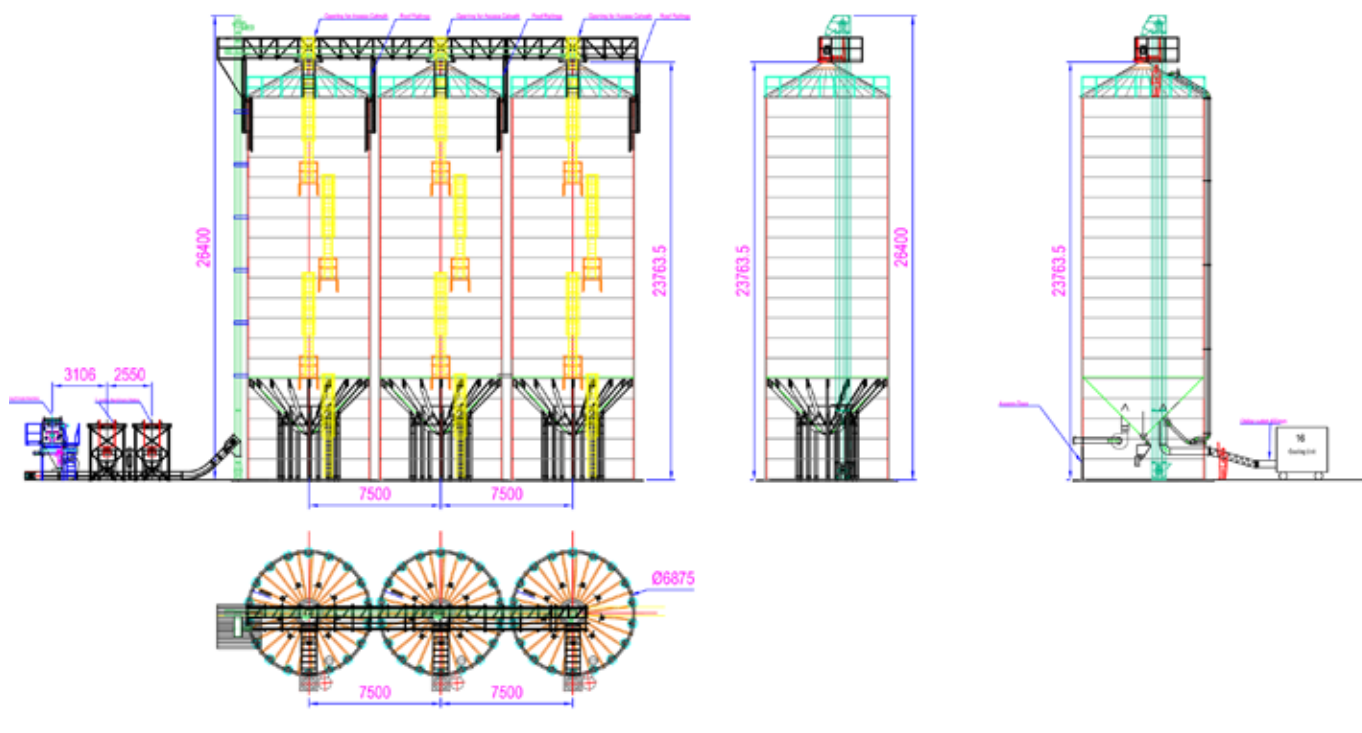

## Products

### Silos

- 3 Hopper Bottom Silos HBS 6,90/14/45

### Steel structures and accessories

- Catwalks
- Platforms and Ladders

## Technical data

Type	HBS
Country	Filipinas
City	Manila
Customer	Indofood
Description	Storage Plant for wheat
Product	Wheat
Storage capacity t	1.500
Project partner	PETKUS Technologie
Year begin	-
Year end	2019

## Services

Basic and Detail Engineering and design of the general layout and flow-chart of the storage area of the plants.

Design of architectural drawing for the civil works calculation and realization.

Steel structures design and static calculation.



## Vall Companys Spain

Year: 2023

Product: Cereal

Storage capacity: 12.240 t

### Location:

Ejea de los Caballeros (España)

### Number and type of Silos:

4 Hopper Bottom Silos HBS-S 13,80/21/45

### Accessories:

Catwalks, platforms and ladders, ventilation system, Temperature and monitoring system.

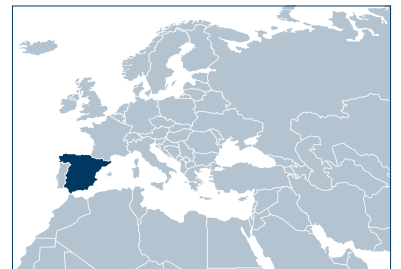

[www.simeza.com](http://www.simeza.com)

**SILOS METÁLICOS ZARAGOZA S.L.U.**

Autovía de Logroño, Km. 14,3

C/ Francia s/n

50180 Utebo (Saragossa)

Spain

T. +34 976 126 060

[simeza@simeza.com](mailto:simeza@simeza.com)



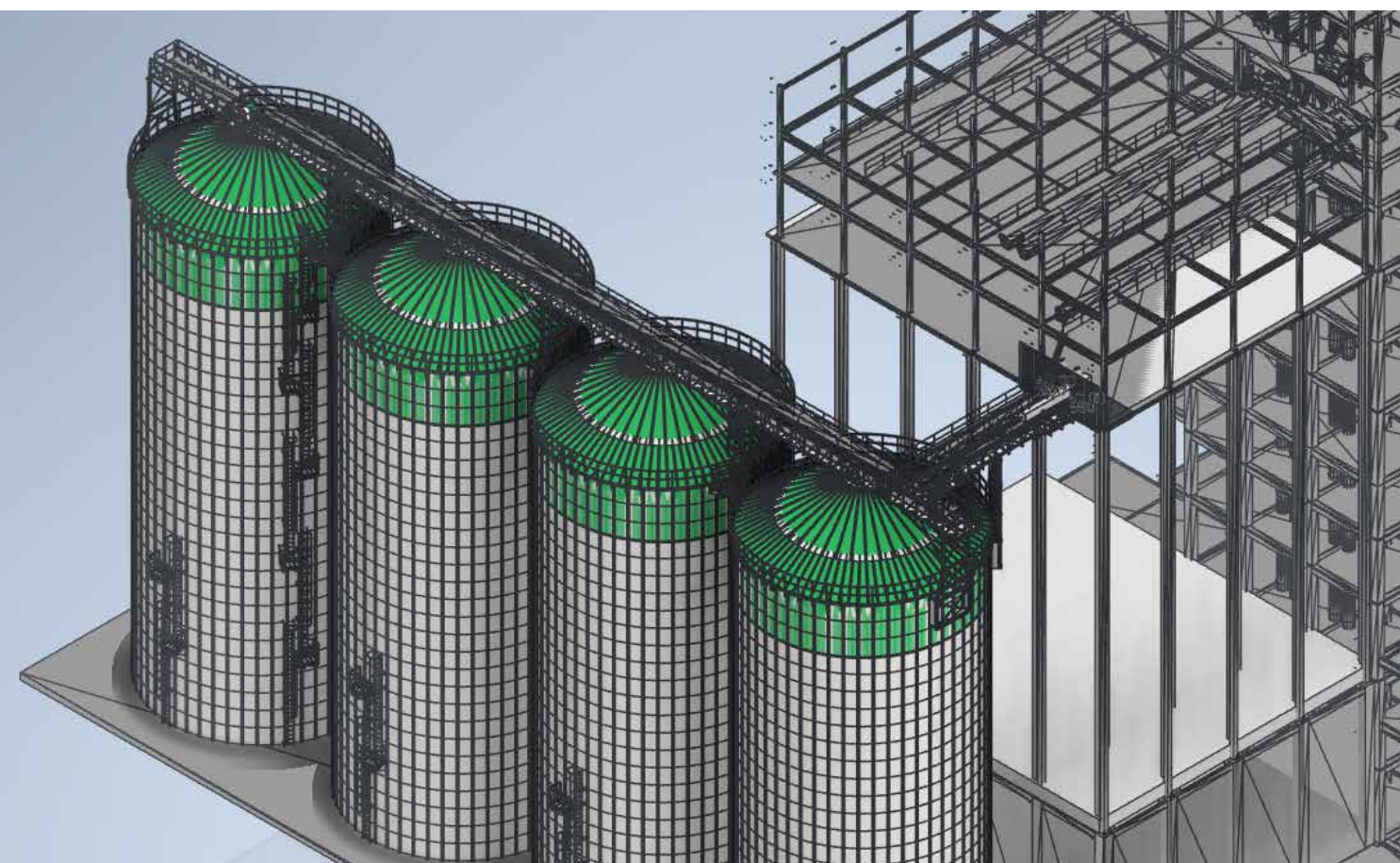

## Products

### Silos

- 4 Hopper Bottom Silos HBS-S 13,80/21/45

### Steel structures and accessories

- Catwalks
- Platforms and Ladders
- Ventilation system
- Temperature and monitoring system

## Technical data

Type	HBS-S
Country	España
City	Ejea de los Caballeros
Customer	Vall Companys
Description	Hopper silos for raw material
Product	Cereal
Storage capacity t	12.240
Project partner	-
Year begin	2023
Year end	2024

## Services

Basic and Detail Engineering and design of the general layout and flow-chart of the storage area of the plants.

Design of architectural drawing for the civil works calculation and realization.

Steel structures design and static calculation.

Delivery of all the silos and accessories.

Supervision.

Commissioning.



# Bulk Discharge Silos

**(TLS)**





## Agrovecó Spain

Year: 2012

Product: Corn

Storage capacity: 170 t

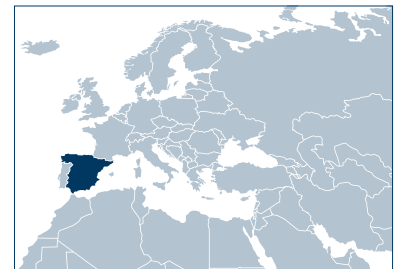

### Location:

Casetas, Zaragoza (Spain)

### Number and type of Silos:

2 Truck Loading Silos TLS-S 3,60/3/60

2 Truck Loading Silos TLS-S 3,80/4/45

### Accessories:

Roof ladder, vertical ladder, support structure.



[www.simeza.com](http://www.simeza.com)

**SILOS METÁLICOS ZARAGOZA S.L.U.**

Autovía de Logroño, Km. 14,3

C/ Francia s/n

50180 Utebo (Saragossa)

Spain

T. +34 976 126 060

[simeza@simeza.com](mailto:simeza@simeza.com)









## Aarhus Omni Bulk As Denmark

Year: 2021

Product: Wood pellets

Storage capacity: 300 t

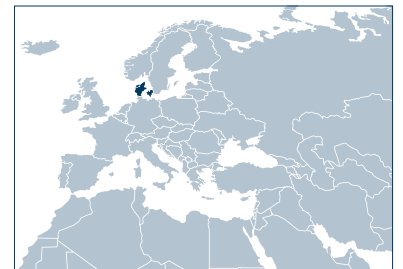

### Location:

Aarhus (Denmark)

### Number and type of Silos:

3 Truck Loading Silos TLS-S 5,30/4/60

1 Truck Loading Silos TLS-S 5,30/2/60

### Accessories:

Roof ladder, vertical ladder, support structure, cone discharge WAM-BIN ACTIVATOR BA210.



[www.simeza.com](http://www.simeza.com)

**SILOS METÁLICOS ZARAGOZA S.L.U.**

Autovía de Logroño, Km. 14,3

C/ Francia s/n

50180 Utebo (Saragossa)

Spain

T. +34 976 126 060

[simeza@simeza.com](mailto:simeza@simeza.com)



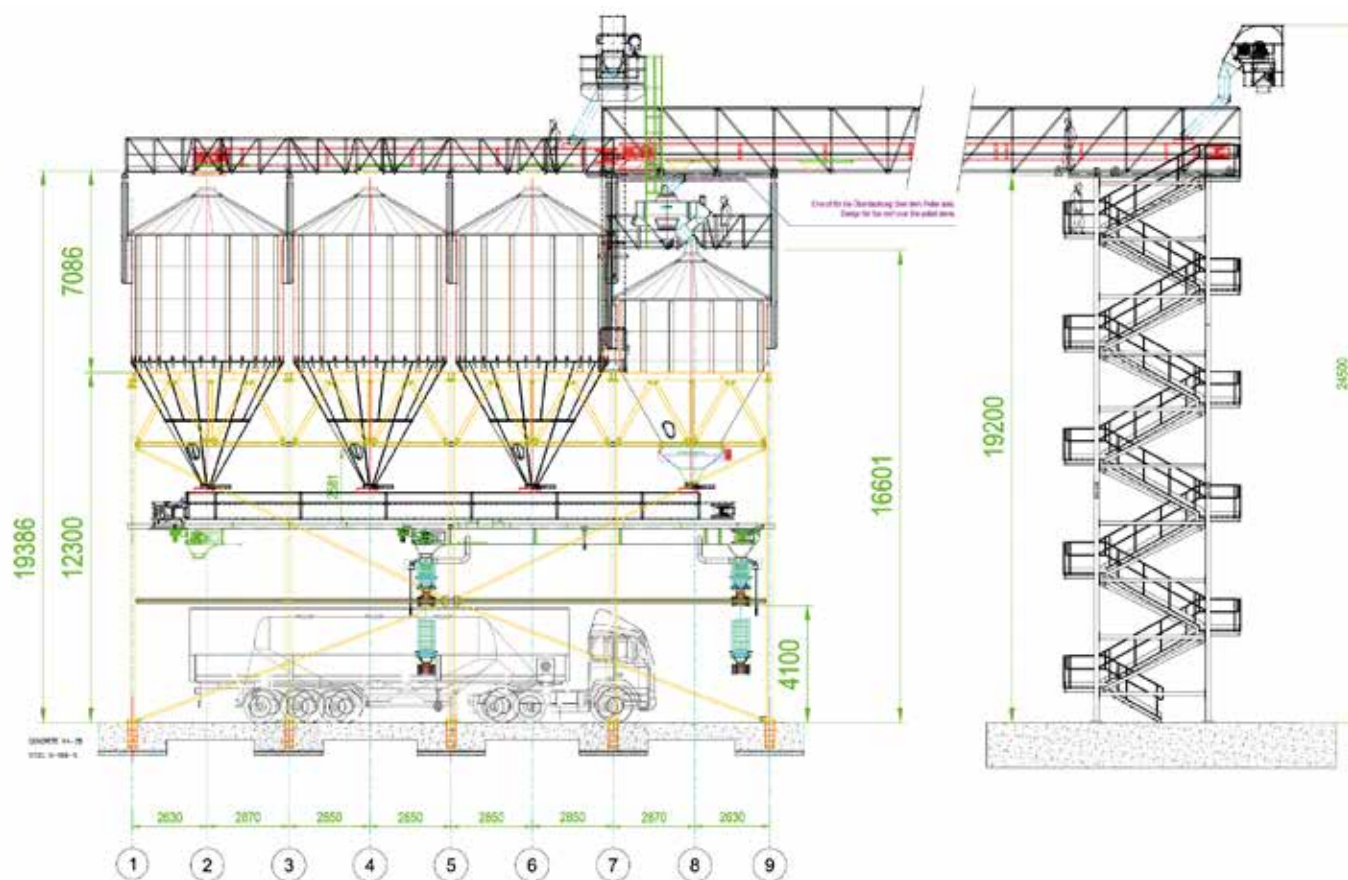

## Products

### Silos

- 3 Truck Loading Silos TLS-S 5,30/4/60
- 1 Truck Loading Silos TLS-S 5,30/2/60

### Steel structures and accessories

- Roof ladder
- Vertical ladder
- Support structure
- Cone discharge WAM-BIN ACTIVATOR BA210

## Technical data

Type	TLS-S
Country	Denmark
City	Aarhus
Customer	Aarhus Omni Bulk As
Description	Truck loading system of wood pellet
Product	Wood pellet
Storage capacity t	300
Project partner	CESCO EPC
Year begin	2021
Year end	2021

## Services

Supply.





## Simatech Port Terminal Dubai (UAE)

Year: 2021

Product: Corn

Storage capacity: 500 t

**Location:**

Dubai (UAE)

**Number and type of Silos:**

4 Truck Loading Silos TLS-S 4,60/8/45

**Accessories:**

Roof ladder, vertical ladder, service platform extension.



[www.simeza.com](http://www.simeza.com)

**SILOS METÁLICOS ZARAGOZA S.L.U.**

Autovía de Logroño, Km. 14,3

C/ Francia s/n

50180 Utebo (Saragossa)

Spain

T. +34 976 126 060

[simeza@simeza.com](mailto:simeza@simeza.com)





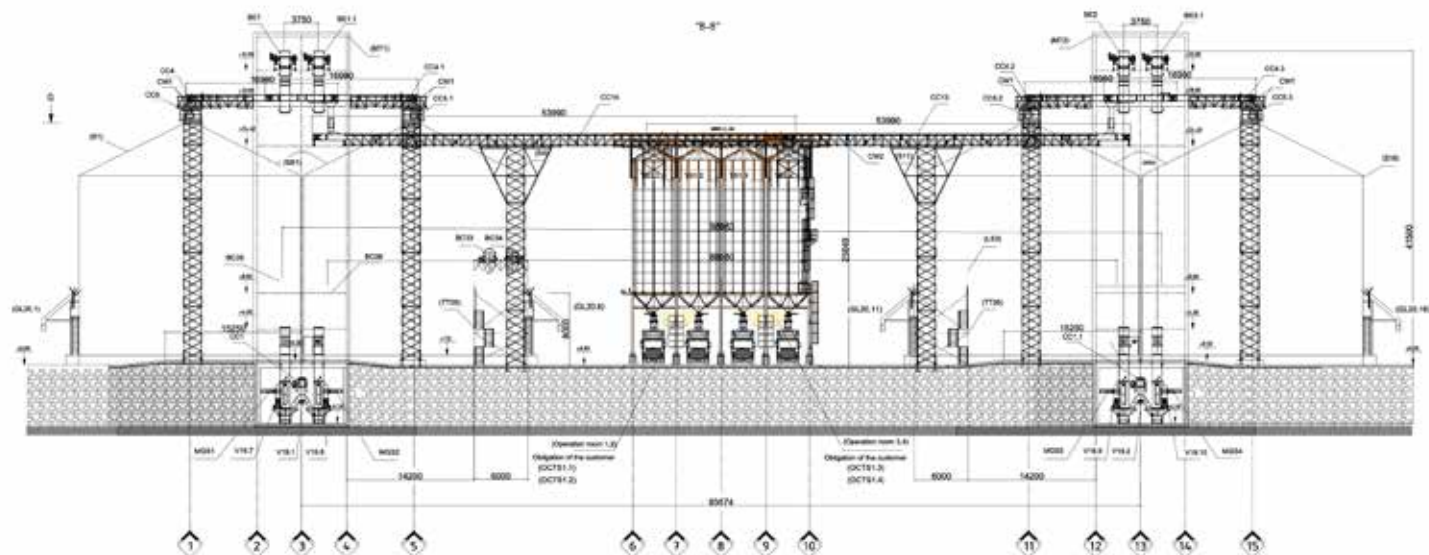

## Products

### Silos

- 4 Truck Loading Silos TLS-S 4,60/8/45

### Steel structures and accessories

- Roof ladder
- Vertical ladder
- Service platform extension

## Technical data

Type	TLS-S
Country	UAE
City	Dubai
Customer	Simatech Port Terminal
Description	Truck loading system in an existing storage plant of concrete silos
Product	Com
Storage capacity t	500
Project partner	CESCO EPC
Year begin	2021
Year end	2021

## Services

Supply.

**TORNUM<sup>®</sup>**



# Farm Silos

**SGC/SSL**





## SAT Anso Spain

Year: 2022

Product: Animal meals

Storage capacity: 17 t

### Location:

Bárboles, Zaragoza (Spain)

### Number and type of Silos:

12 Farm Silos SGC-A 2,50/03/62

### Compact Capacity (+6%):

18 t

### Accessories:

Vertical ladder with guardrails and a roof ladder with railing, outlet flange, connection plate between the cylinder and the hopper, fasteners and sealant necessary for the construction of the silo.

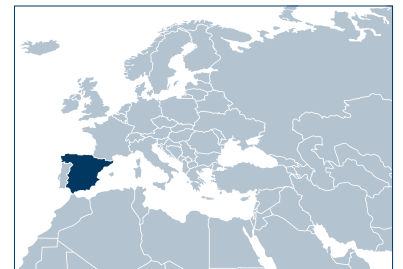

[www.simeza.com](http://www.simeza.com)

**SILOS METÁLICOS ZARAGOZA S.L.U.**

Autovía de Logroño, Km. 14,3

C/ Francia s/n

50180 Utebo (Saragossa)

Spain

T. +34 976 126 060

[simeza@simeza.com](mailto:simeza@simeza.com)







## Products

### Silos

- 12 Farm Silos SGC-A 2,50/03/62

### Steel structures and accessories

- Vertical ladder with guardrails
- Roof ladder with railing
- Outlet flange
- Connection plate
- Fasteners and sealant

## Technical data

Type	SGC-A
Country	Spain
City	Bárboles, Zaragoza
Customer	SAT Anso
Description	Farm silos for feed storage
Product	Animal feed
Storage capacity t	17
Project partner	-
Year begin	2022
Year end	2022

## Services

Supply.

# Tanks

**(DP)**





## ISAV Bulgaria

Year: 2023

Product: Water

Storage capacity: 100 m3

**Location:**

Pazardzhik (Bulgaria)

**Number and type of Silos:**

1 Water Tank DPT 5,30/04

**Accessories:**

Ladder



[www.simeza.com](http://www.simeza.com)

**SILOS METÁLICOS ZARAGOZA S.L.U.**

Autovía de Logroño, Km. 14,3

C/ Francia s/n

50180 Utebo (Saragossa)

Spain

T. +34 976 126 060

[simeza@simeza.com](mailto:simeza@simeza.com)







## Products

### Tanks

1 Water Tank DPT 5,30/04

### Steel structures and accessories

Ladder

## Technical data

Type	DPT
Country	Bulgaria
City	Pazardzhik
Customer	ISAV
Description	Water tank with ladder to access the roof and inspection platform
Product	Water
Storage capacity m3	100
Project partner	-
Year begin	2023
Year end	2023

## Services

Supply.

# 360 DEGREE SOLUTIONS FOR YOUR STORAGE

#EVERYWHEREINTHEWORLD



[www.simeza.com](http://www.simeza.com)



SCAN AND DISCOVER  
**SIMEZA**

**TORNUM<sup>®</sup>**